



2/48 Huon Crescent LEOPOLD, VIC



2



1



1

## Low-Maintenance Living That Feels Like Home! - Private Inspections Only

Have you been searching for low-maintenance living that feels just like home? Whether you're dreaming of breaking into the property market, searching for a superb downsizer, or hoping to grow your investment portfolio, this is the one for you!

**Price:** \$495,000 - \$544,000

**Property Type:** Unit

**Land:** 366 m2

You'll need to act swiftly to secure this Leopold gem!

# HAYDEN

**Karen Purcell**

0448510143

karenp@haydenleopold.com.au

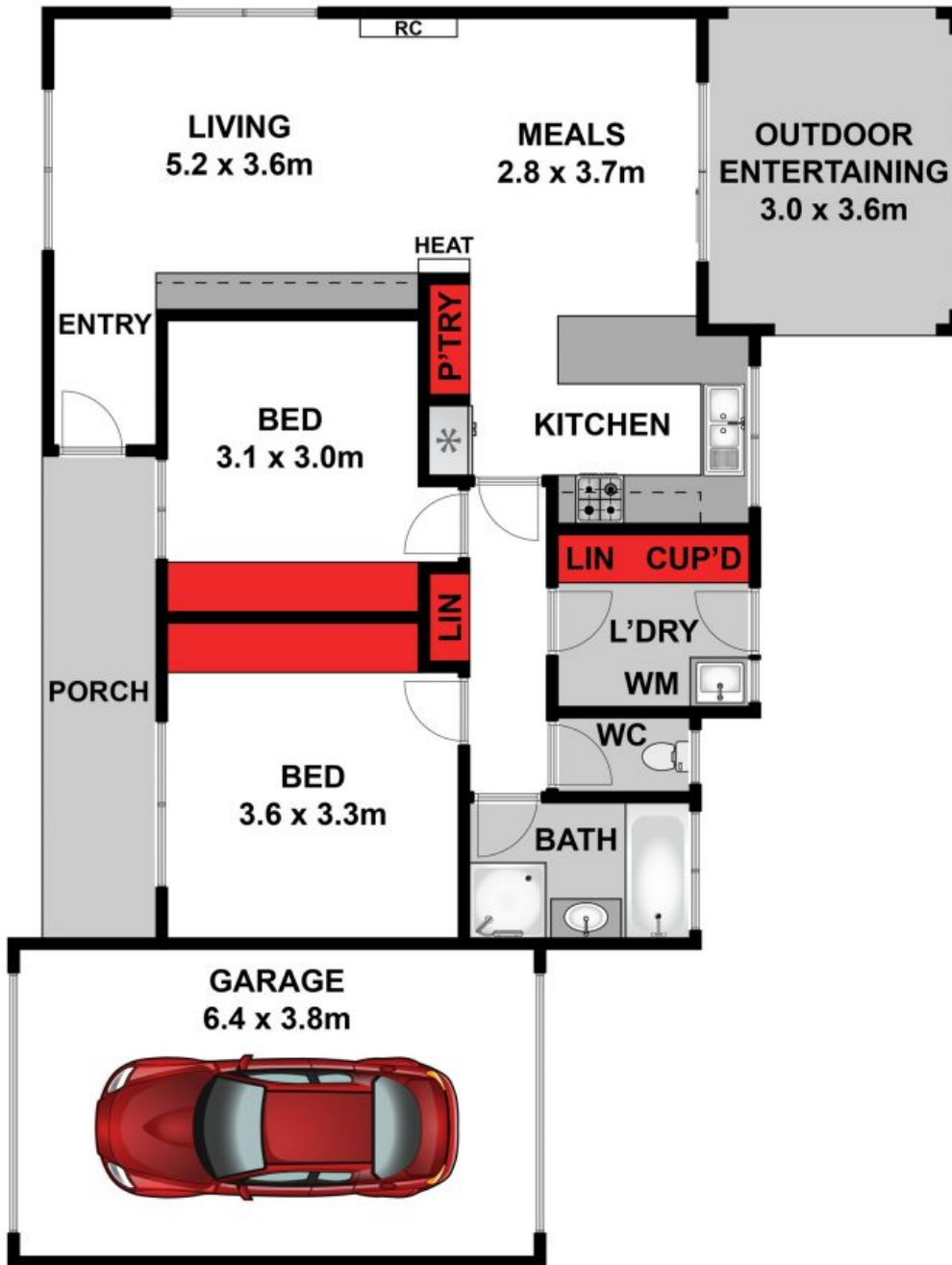

Whilst [bwrn.com.au](http://bwrn.com.au) has made every attempt to ensure the accuracy of the floor plan contained here, measurements are approximate and no responsibility is taken for any error, omission, or mis-statement. This plan is for illustrative purposes only.



**2/48 Huon Crescent, Leopold**

**HAYDEN**

**2/48 Huon Crescent**

**LEOPOLD, VIC**