



10-12 Newcombe Street DRYSDALE, VIC



Immense Charm, History and Casual Elegance

Also on offer is the adjoining block of land, (approx 1700sqm) comprising a large three phase powered shed. Zoned residential, this is an attractive opportunity for the astute purchaser. "Corio Lynn" is a unique property with over a 100 years of history, offering an idyllic lifestyle but with all the coastal assets and schools within easy reach.

Price: \$1,200,000-\$1,300,000
Property Type: House
Land: 3556 m2

HAYDEN

Hayden Real Estate -

Ocean Grove
 samh@hayden.com.au

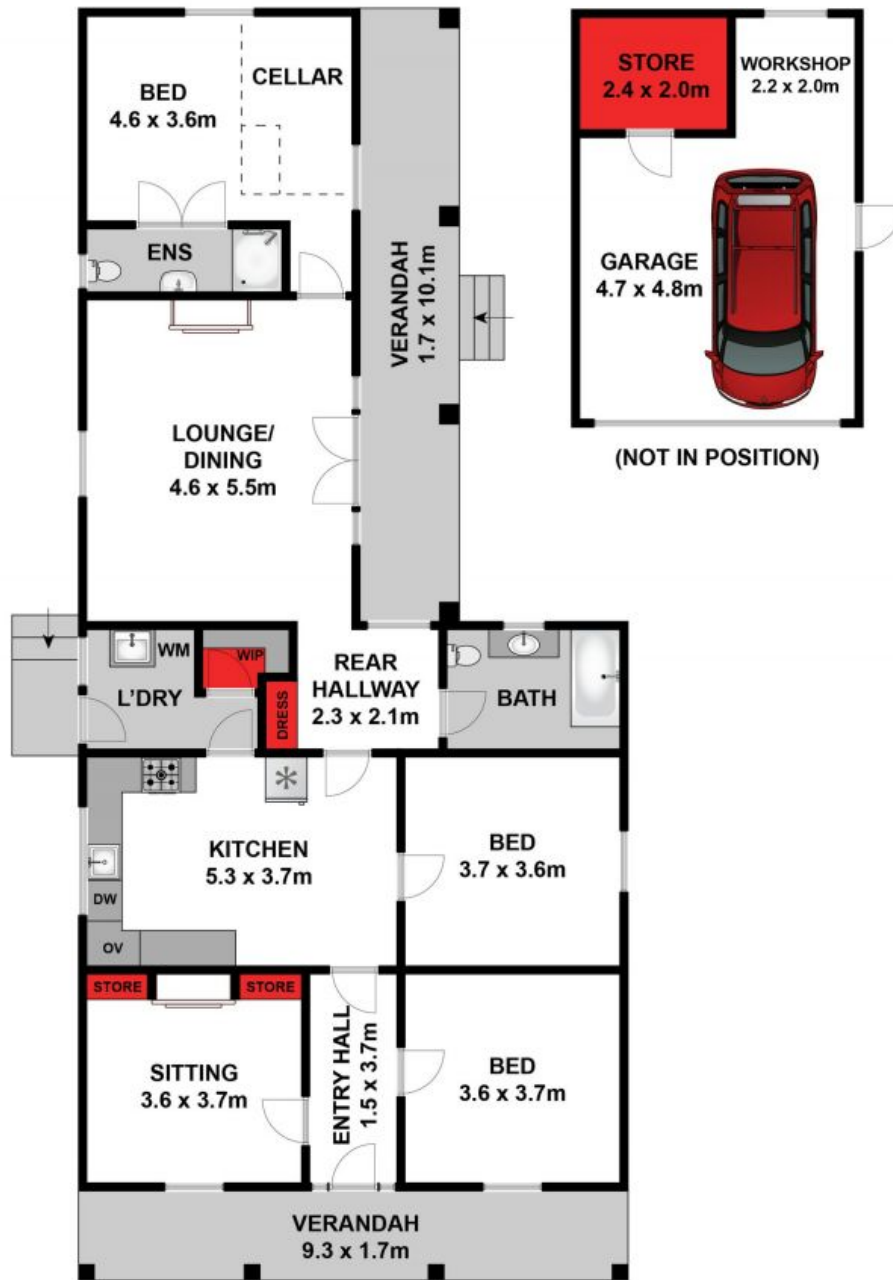

Whilst bwrn.com.au has made every attempt to ensure the accuracy of the floor plan contained here, measurements are approximate and no responsibility is taken for any error, omission, or mis-statement. This plan is for illustrative purposes only.



10 Newcombe Street, Drysdale

HAYDEN

10-12 Newcombe Street

DRYSDALE, VIC