



10-12 Newcombe Street DRYSDALE, VIC



4



2



2

## Immense Charm, History and Casual Elegance

Also on offer is the adjoining block of land, (approx 1700sqm) comprising a large three phase powered shed. Zoned residential, this is an attractive opportunity for the astute purchaser. "Corio Lynn" is a unique property with over a 100 years of history, offering an idyllic lifestyle but with all the coastal assets and schools within easy reach.

**Price:** \$1,200,000-\$1,300,000  
**Property Type:** House  
**Land:** 3556 m2

# HAYDEN

Hayden Real Estate -

**Ocean Grove**  
 samn@hayden.com.au

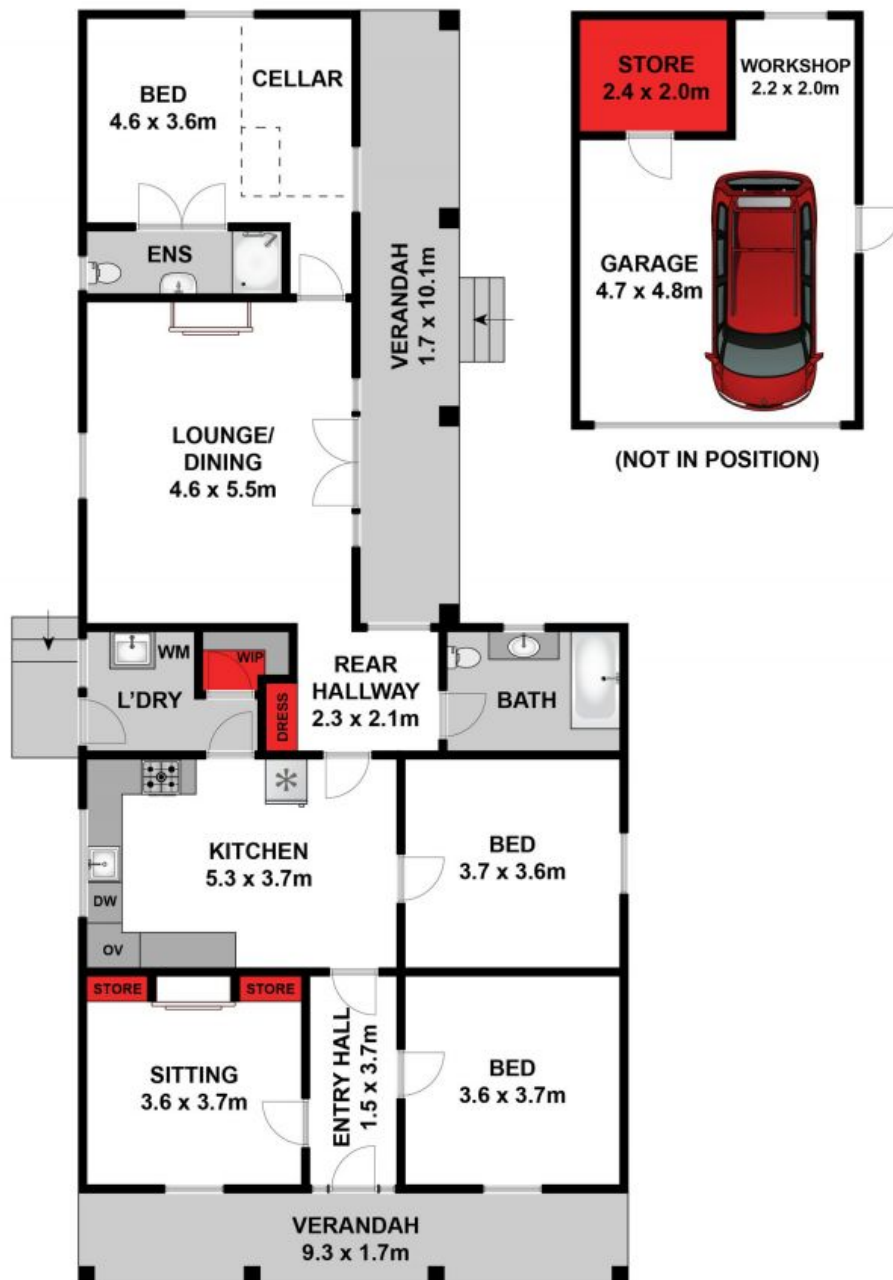

Whilst [bwrn.com.au](http://bwrn.com.au) has made every attempt to ensure the accuracy of the floor plan contained here, measurements are approximate and no responsibility is taken for any error, omission, or mis-statement. This plan is for illustrative purposes only.



**10 Newcombe Street, Drysdale**

**HAYDEN**

**10-12 Newcombe Street**

**DRYSDALE, VIC**