



58/33 Fourteenth Road CONNEWARRE, VIC



2



1



1

## Investment and Holiday Retreat!

Other Features include:

- A contemporary bathroom with a large shower, vanity
- Open plan living with north-facing natural light
- Stainless steel appliances
- Floor-to-ceiling sliding doors lead out to the balcony
- Split system air conditioner
- Pool access
- Tennis Courts access
- Geelong CDB is approximately 20 mins away
- Shared laundry facilities

\*\* Not for permanent living \*\*

**Price:** \$420,000-\$440,000

**Property Type:** Apartment

# HAYDEN

**Penny Dawson**

0448510200

penny@haydenoceanogrove.com.

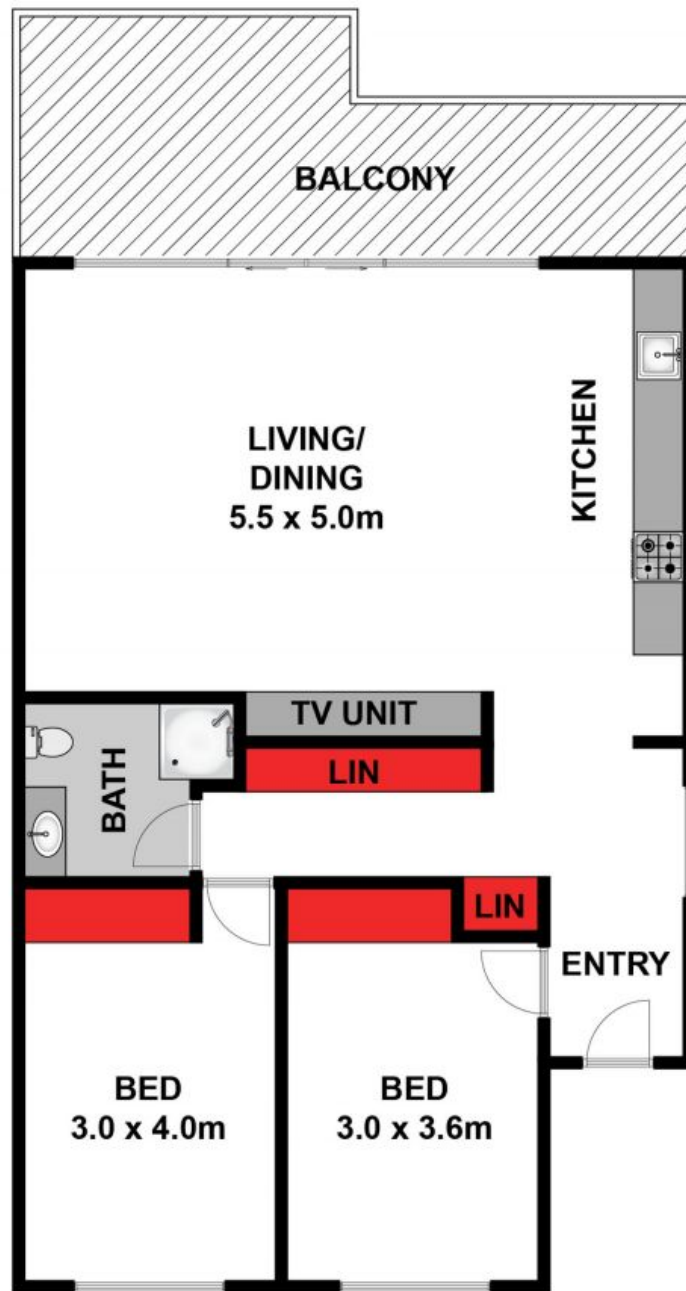

Approx. Area 92m<sup>2</sup>

Whilst [bwrm.com.au](http://bwrm.com.au) has made every attempt to ensure the accuracy of the floor plan contained here, measurements are approximate and no responsibility is taken for any error, omission, or mis-statement. This plan is for illustrative purposes only.

**58/33 Fourteenth Road, Connewarre**

**HAYDEN**

**58/33 Fourteenth Road**

**CONNEWARRE, VIC**