



3 Betleigh Street ANGLESEA, VIC



3



2

A Private Coastal Oasis!

Set amid natural bushland surrounds, moments from Anglesea village and the nearby river, with access to an abundance of walking trails and reserves to explore, the beautiful treelined Betleigh St is a private oasis. Whether it's riding at the dedicated bike park a few minutes away or endless days at the local beaches, this home is perfectly located so you can have it all.

Escape to an enviable lifestyle at 3 Betleigh St, perfectly positioned to make the most of coast living with everything right at your fingertips. Old world charm, a welcoming floorplan, with multiple living spaces and generous proportions, this one is ready now with opp

Price: Contact Agent
Property Type: House
Land: 1366 m2

HAYDEN

Darcy Bennett

0468427359

darcyb@hayden.com.au

Bryan Hayden

0417613250

bryanh@hayden.com.au

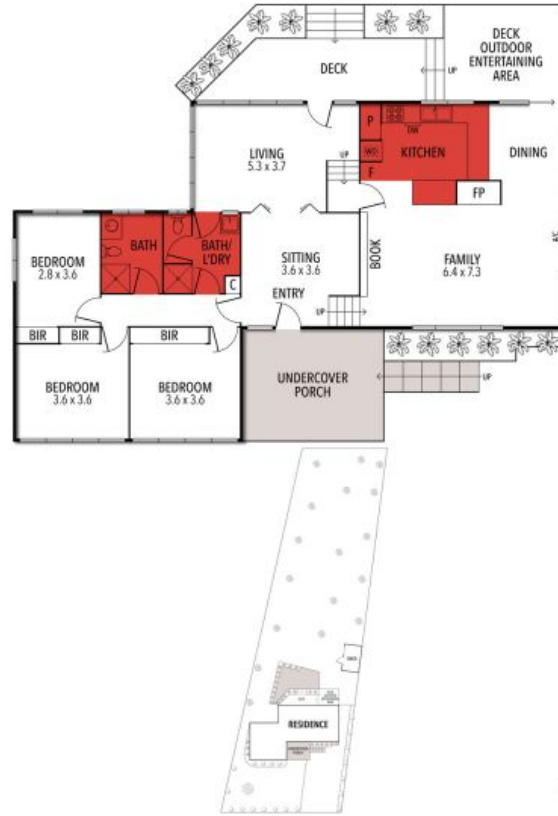

THE ABOVE PLAN IS AN ARTIST'S IMPRESSION ONLY. IT INCLUDES ELEMENTS THAT ARE FOR DISPLAY PURPOSES ONLY AND MAY NOT BE TO SCALE.
LANDSCAPING SHOWN IS INDICATIVE ONLY. DIMENSIONS ARE APPROXIMATE.