



32 Yeoman Crescent LEOPOLD, VIC



4



2



2

Your Dream Lifestyle Starts Here?

This superb residence creates a spacious haven for the whole family to enjoy!

The main bedroom creates a private retreat for parents with a walk-in robe and en suite. Three additional bedrooms with built-in robes are tucked away in a separate wing, close to the main bathroom and separate toilet. The laundry and walk-in linen press complete the flexible layout. You'll be in the utmost comfort thanks to ducted heating, evaporative cooling and a split-system air conditioner.

When it comes to outdoor living options, this home is an absolute treat. Whether you want to soak up the sunshine or relax under the shade of the retractable awning, the alfresco deck will effortlessly accommodate. You'll love that café blinds enclose a section of the deck for the cooler months. Children have plenty of room to run and play in the spacious ba

Price: \$800,000 - \$880,000

Property Type: House

Land: 648 m2

HAYDEN

Karen Purcell

0448510143

karenp@haydenleopold.com.au

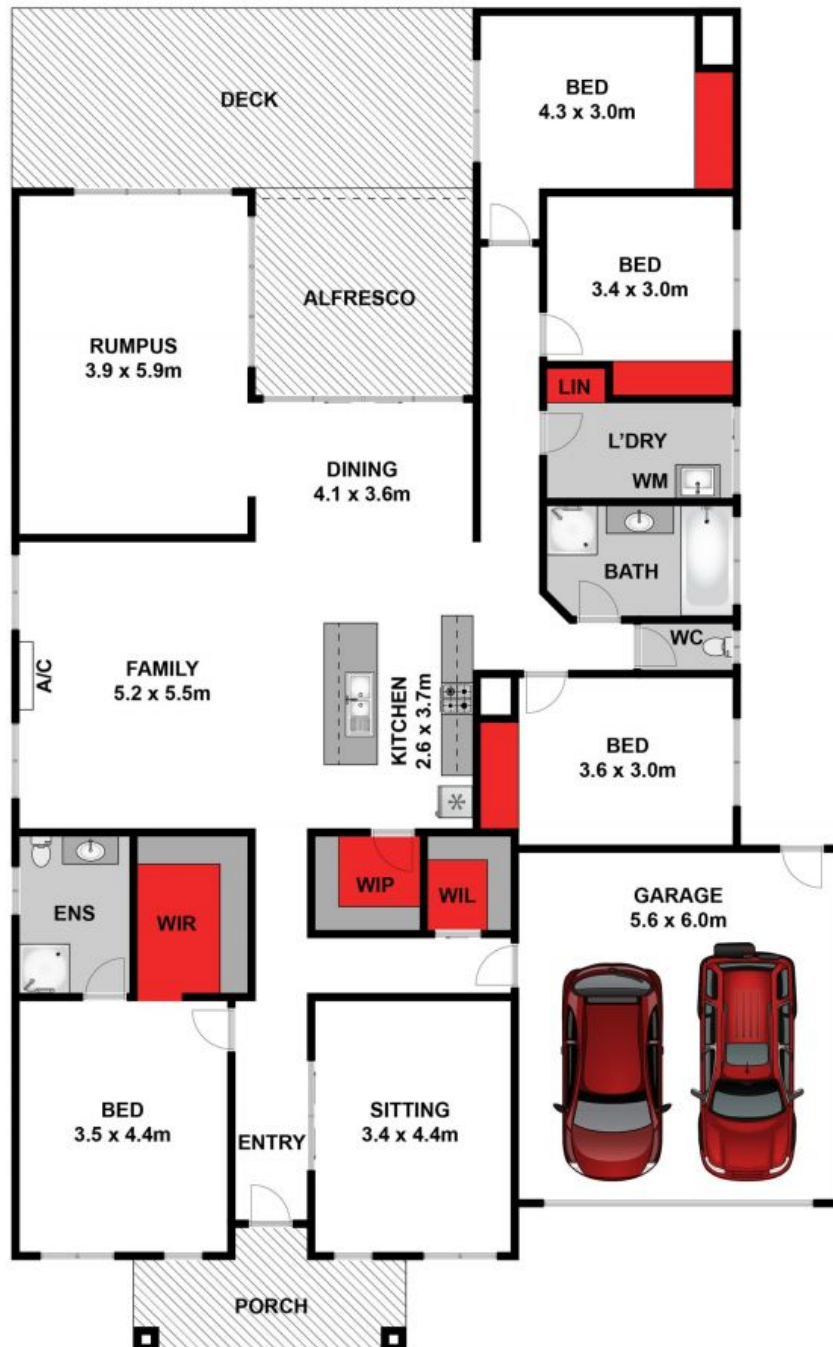

Whilst bwrn.com.au has made every attempt to ensure the accuracy of the floor plan contained here, measurements are approximate and no responsibility is taken for any error, omission, or mis-statement. This plan is for illustrative purposes only.



32 Yeoman Crescent, Leopold

HAYDEN

32 Yeoman Crescent

LEOPOLD, VIC