



41 Grassland Grove LEOPOLD, VIC



3



2



2

## Carefree Living Overlooking The Park!

Overlooking the local parkland, this home presents an irresistible choice for first homebuyers, young families and downsizers alike!

The new carpet enhances the spotless interiors, inviting you to move straight in and instantly enjoy. Morning light sweeps through the open plan living/dining/kitchen zone, which opens onto the sheltered alfresco area for relaxed family living. The kitchen takes care of all your cooking needs with a built-in pantry and stainless steel appliances (dishwasher, oven, gas cooktop, rangehood).

The open parkland features a playground and direct access to the Bellarine Rail Trail, making this an ideal choice for those who love to venture outdoors. Public transport and the Leopold Sportsmans Club are a short stroll away, while the delights of Gateway Plaza are w

**Price:** \$590,000 - \$645,000

**Property Type:** House

**Land:** 400 m2

# HAYDEN

**Karen Purcell**

0448510143

karenp@haydenleopold.com.au

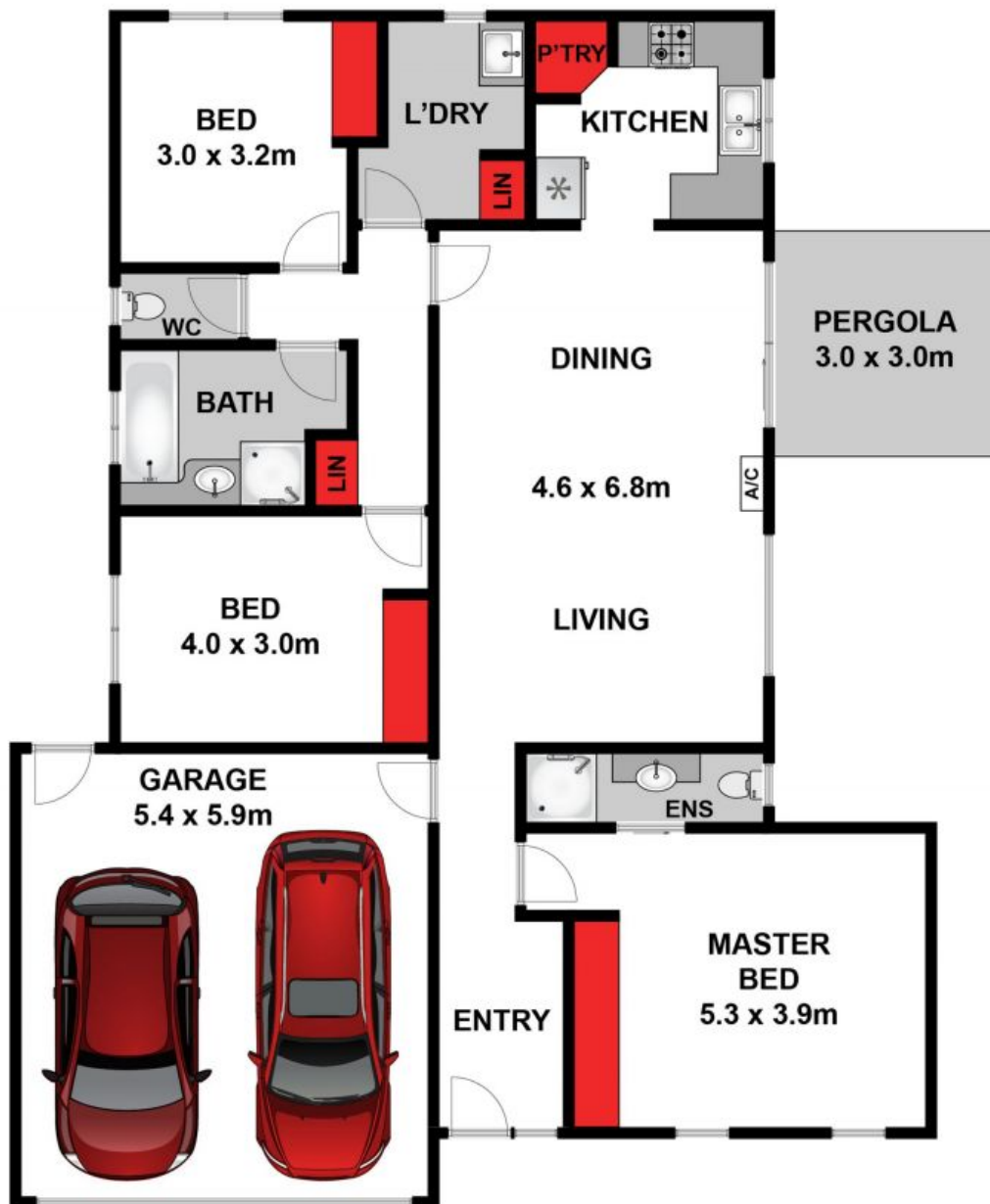

Whilst [bwrn.com.au](http://bwrn.com.au) has made every attempt to ensure the accuracy of the floor plan contained here, measurements are approximate and no responsibility is taken for any error, omission, or mis-statement. This plan is for illustrative purposes only.



**41 Grassland Grove, Leopold**

**HAYDEN**

**41 Grassland Grove**

**LEOPOLD, VIC**