



40 Emperor Drive OCEAN GROVE, VIC



3



2



2

## Between the Beach and the Wetlands

Just minutes from Ocean Grove's famous beachfront, this charming three bedroom home offers the chance to live the quintessential coastal lifestyle. Whether it's morning walks along the beach, exploring the adjacent Begola Wetlands or proximity to local schools, shops and cafes - spend more time living the life and less in the car. It features three generously sized bedrooms, two living areas, RCACs, DLUG, large north-facing backyard and covered outdoor entertaining.

**Price:** \$1,200,000 - \$1,300,000

**Property Type:** House

**Land:** 652 m2

# HAYDEN

**Lynley Bassett**

0448515925

lynley@haydenoceanogrove.com.au

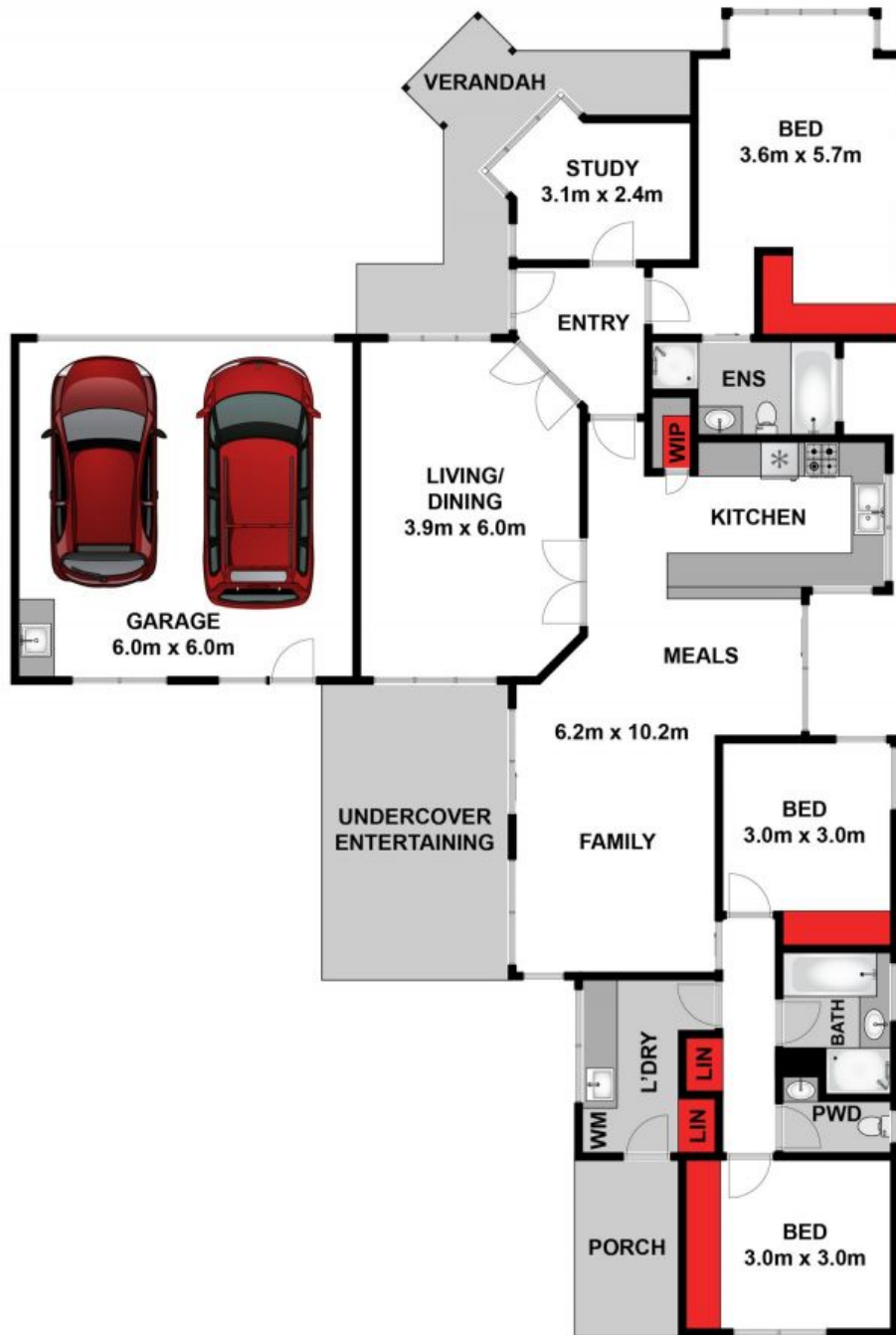

Whilst [bwrn.com.au](http://bwrn.com.au) has made every attempt to ensure the accuracy of the floor plan contained here, measurements are approximate and no responsibility is taken for any error, omission, or mis-statement. This plan is for illustrative purposes only.



**40 Emperor Drive, Ocean Grove**

**HAYDEN**

**40 Emperor Drive**

**OCEAN GROVE, VIC**