

791 Bellarine Highway LEOPOLD, VIC



2



1



3

## Fabulous Holiday or Retirement home ! LOCATION LOCATION!

Call to arrange a Private inspection :

The front garden is private and leafy, with a covered entryway opening onto a central hall. With new plush carpet throughout and crisply finished white walls, the interior is calm and modern. A main living space, with plenty of light and views to the greenery outside, flows through to the kitchen/dining. Stainless steel appliances, gas cooking and plenty of storage above and below make the as-new kitchen stylish and functional.

Two well-sized bedrooms both enjoy plenty of natural light and plush carpet flooring whilst a beautifully updated family bathroom sits adjacent. A hallway linen cupboard offers convenient added storage space and the laundry has a full sized trough and access to a second toilet. A covered entertaining area at the rear of the house overlooks the substantial inground pool and a rumpus/office space enjoys direct access to outside. With the house situ

**Price:** \$650,000-\$700,000

**Property Type:** House

**Land:** 908 m2

# HAYDEN

**Penny Dawson**

0448510200

penny@haydenoceanogrove.com.

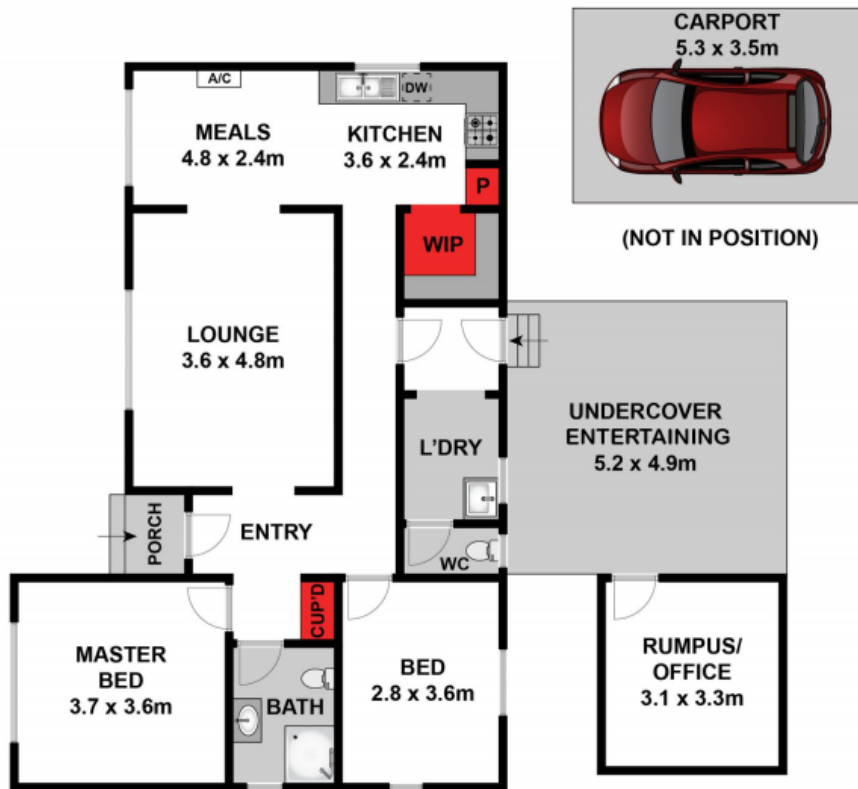

GROUND FLOOR

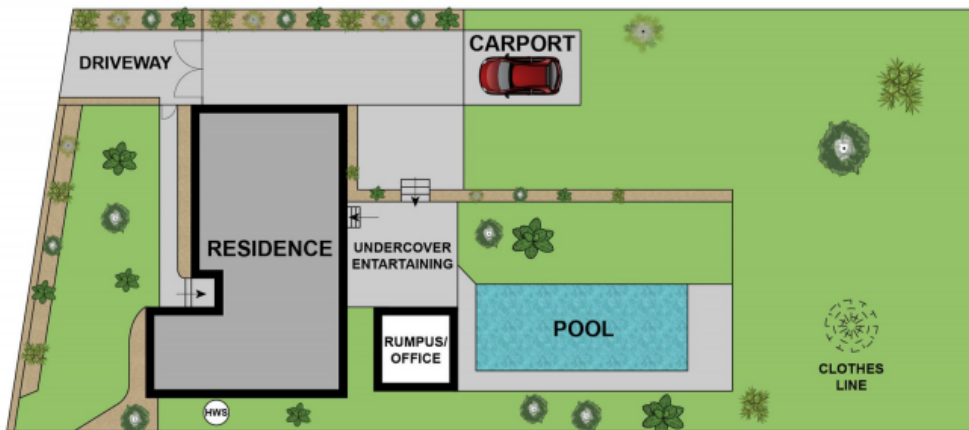

SITE PLAN

Whilst [bwrn.com.au](http://bwrn.com.au) has made every attempt to ensure the accuracy of the floor plan contained here, measurements are approximate and no responsibility is taken for any error, omission, or mis-statement. This plan is for illustrative purposes only.



791 Bellarine Highway, Leopold

**HAYDEN**

791 Bellarine Highway

LEOPOLD, VIC