

791 Bellarine Highway LEOPOLD, VIC



2



1



3

Fabulous Holiday or Retirement home ! LOCATION LOCATION!

Call to arrange a Private inspection :

The front garden is private and leafy, with a covered entryway opening onto a central hall. With new plush carpet throughout and crisply finished white walls, the interior is calm and modern. A main living space, with plenty of light and views to the greenery outside, flows through to the kitchen/dining. Stainless steel appliances, gas cooking and plenty of storage above and below make the as-new kitchen stylish and functional.

Two well-sized bedrooms both enjoy plenty of natural light and plush carpet flooring whilst a beautifully updated family bathroom sits adjacent. A hallway linen cupboard offers convenient added storage space and the laundry has a full sized trough and access to a second toilet. A covered entertaining area at the rear of the house overlooks the substantial inground pool and a rumpus/office space enjoys direct access to outside. With the house situ

Price: \$650,000-\$700,000

Property Type: House

Land: 908 m2

HAYDEN

Penny Dawson

0448510200

penny@haydenoceanogrove.com.

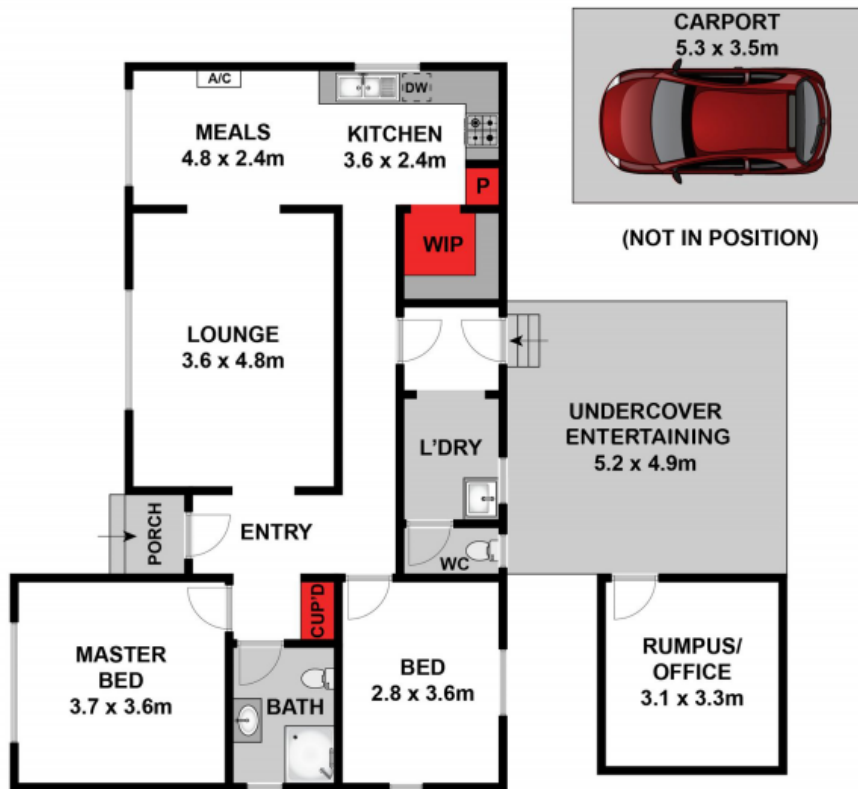

GROUND FLOOR

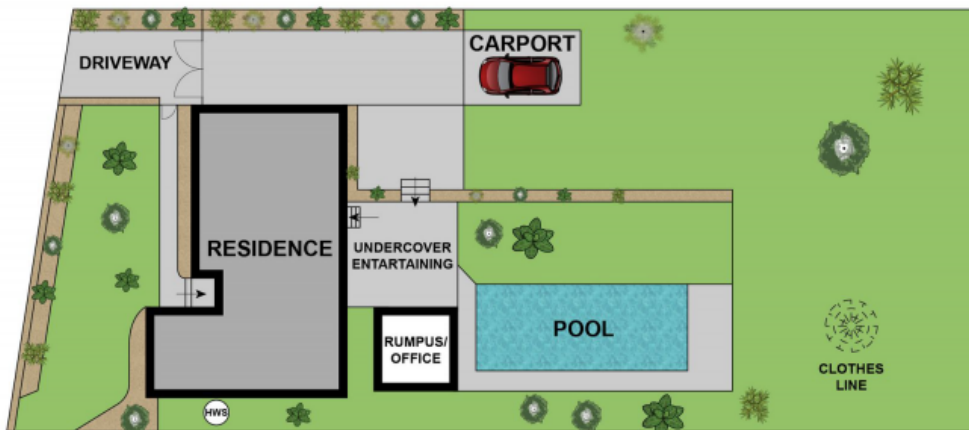

SITE PLAN

Whilst bwrn.com.au has made every attempt to ensure the accuracy of the floor plan contained here, measurements are approximate and no responsibility is taken for any error, omission, or mis-statement. This plan is for illustrative purposes only.



791 Bellarine Highway, Leopold

HAYDEN

791 Bellarine Highway

LEOPOLD, VIC