



39 Trumper Crescent LEOPOLD, VIC



4



2



6

## Spacious Family Living With A Huge Work Shed!

Have you been searching for a spacious family home that ticks every box? Situated on approx. 884m<sup>2</sup>, this property will impress with three living zones, a huge backyard and approx. 7.6 x 12-metre work shed!

The main bedroom creates a generous retreat for parents, complete with a walk-in robe and en suite. Two additional bedrooms with built-in robes share close access to the main bathroom, while the laundry and separate toilet add the final touch to the layout. Ducted heating keeps you cosy during the cooler months.

Outside, the backyard creates the ultimate setting for outdoor family fun. The spacious entertaining deck is perfect for hosting loved ones, while children have plenty of room to play on the lush lawn. The backyard is also home to a veggie garden and two rainwater tanks. One 27,000 litre tank (approx.) for the gardens, the other a smaller tank for internal

**Price:** \$870,000 - \$930,000

**Property Type:** House

**Land:** 884 m<sup>2</sup>

# HAYDEN

**Karen Purcell**

0448 510 143

karenp@haydenleopold.com.au

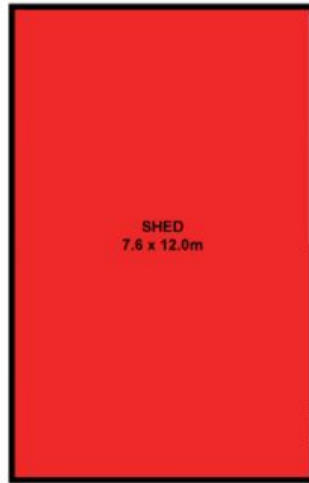

SHED  
7.6 x 12.0m

(NOT IN POSITION)



COVERED  
ENTERTAINMENT  
3.6 x 9.0m

(NOT IN POSITION)

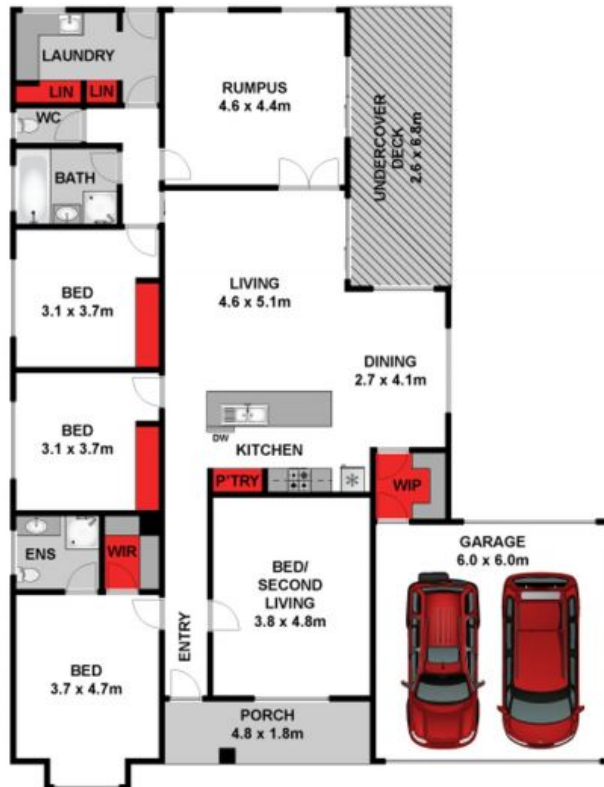

Whilst [bwrn.com.au](http://bwrn.com.au) has made every attempt to ensure the accuracy of the floor plan contained here, measurements are approximate and no responsibility is taken for any error, omission, or mis-statement. This plan is for illustrative purposes only.

## 39 Trumper Crescent, Leopold

