



150 Beacon Point Road CLIFTON SPRINGS, VIC



3



1



4

## A Family Home or Holiday Home Ready to Welcome

Walk through the front door of this 3-bedroom family home and straight into a spacious living room with polished wooden floorboards, and enjoy the sun beaming down through the large corner windows. Wander into the well-proportioned kitchen with dishwasher, electric wall oven and gas-top stove - plenty of cupboard space and beautiful double windows.

**Price:** \$600,000 - \$650,000  
**Property Type:** House  
**Land:** 607 m<sup>2</sup>

# HAYDEN

**Karen Purcell**

0448 510 143

karenp@haydenleopold.com.au

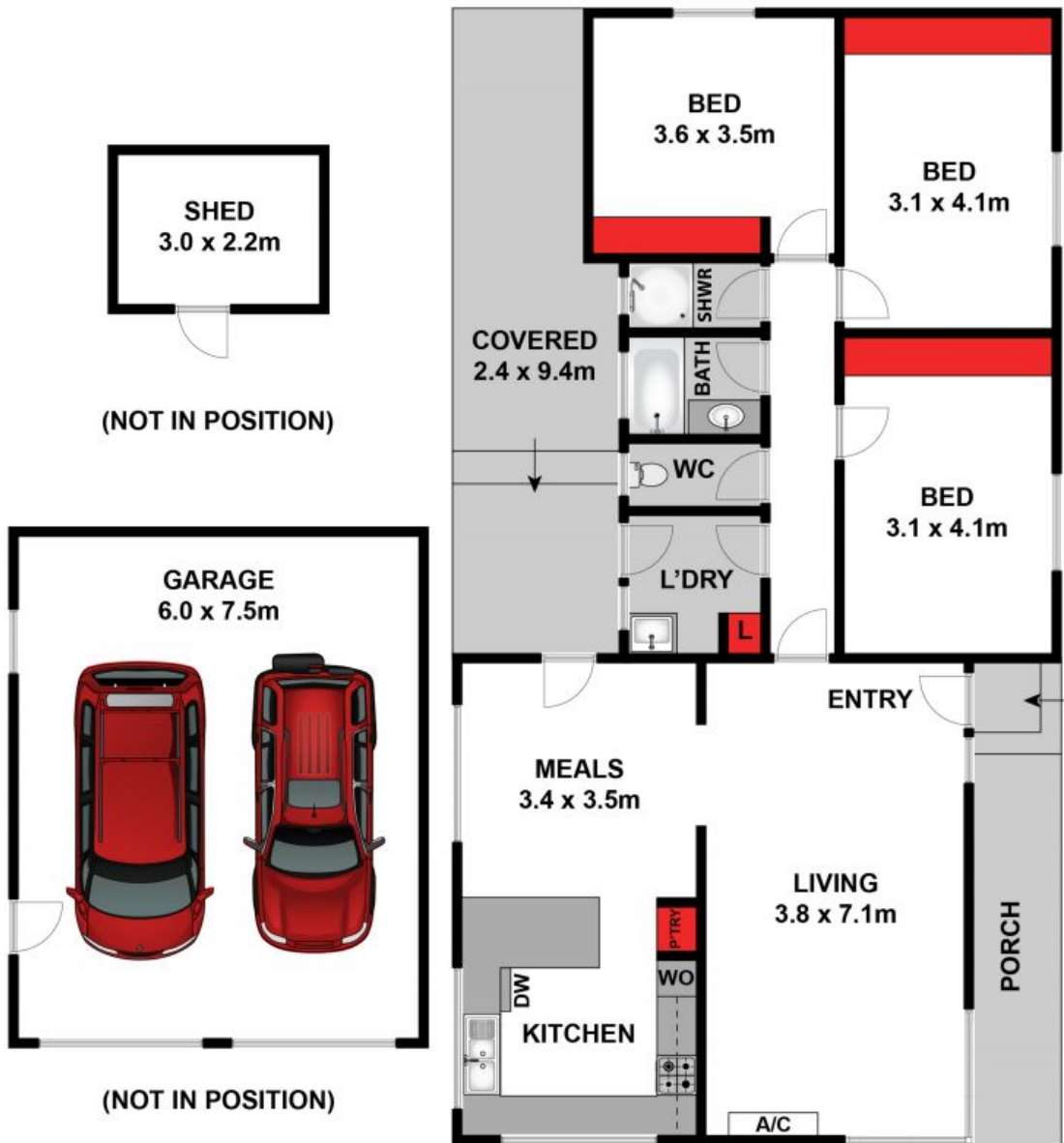

Whilst [bwr.com.au](http://bwr.com.au) has made every attempt to ensure the accuracy of the floor plan contained here, measurements are approximate and no responsibility is taken for any error, omission, or mis-statement. This plan is for illustrative purposes only.

150 Beacon Point Road, Clifton Springs **HAYDEN**

150 Beacon Point Road

CLIFTON SPRINGS, VIC