



150 Beacon Point Road CLIFTON SPRINGS, VIC



3



1



4

A Family Home or Holiday Home Ready to Welcome

Walk through the front door of this 3-bedroom family home and straight into a spacious living room with polished wooden floorboards, and enjoy the sun beaming down through the large corner windows. Wander into the well-proportioned kitchen with dishwasher, electric wall oven and gas-top stove - plenty of cupboard space and beautiful double windows.

Price: \$600,000 - \$650,000
Property Type: House
Land: 607 m2

HAYDEN

Karen Purcell

0448510143

karenp@haydenleopold.com.au

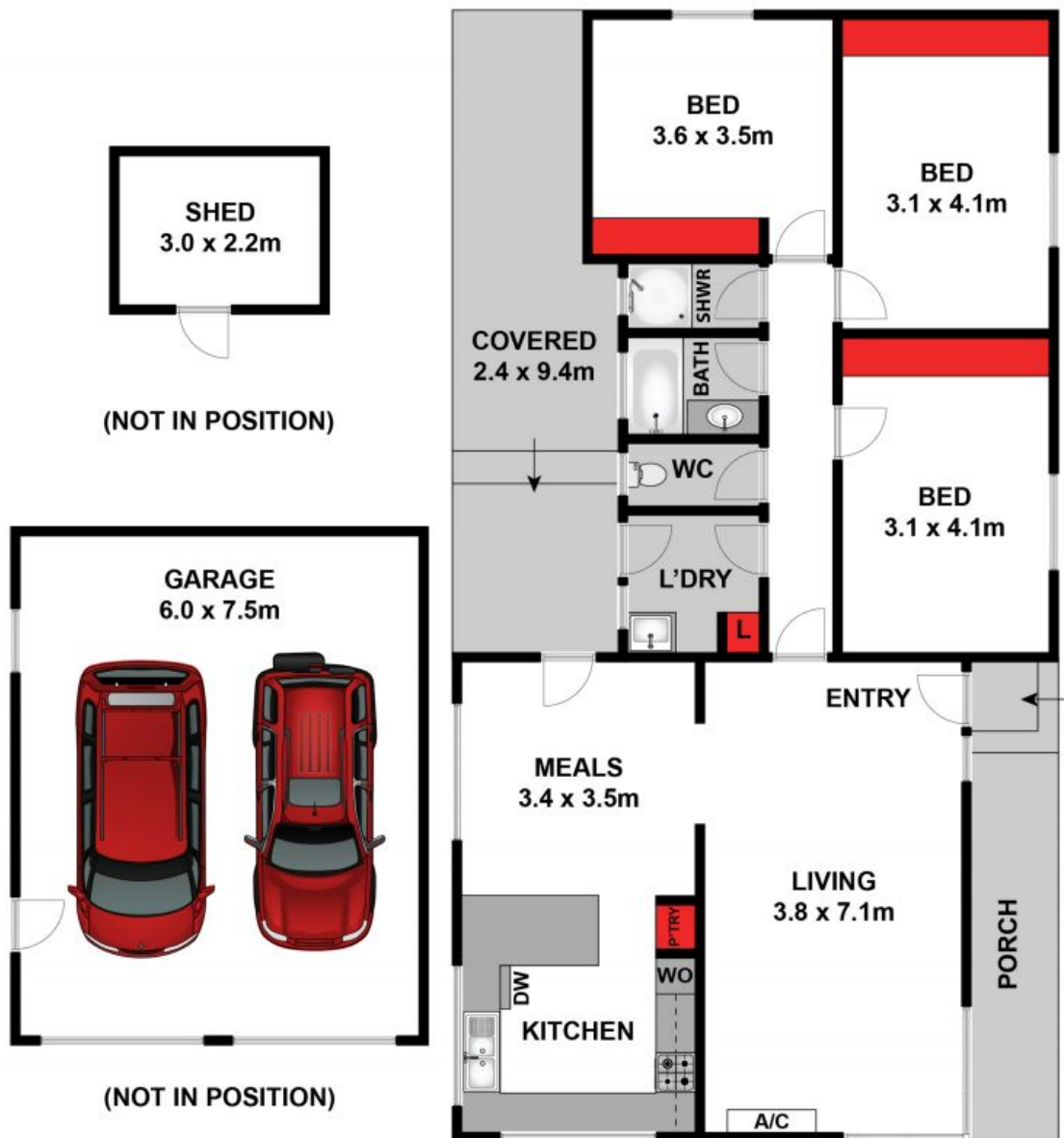

Whilst bwrn.com.au has made every attempt to ensure the accuracy of the floor plan contained here, measurements are approximate and no responsibility is taken for any error, omission, or mis-statement. This plan is for illustrative purposes only.

150 Beacon Point Road, Clifton Springs **HAYDEN**

150 Beacon Point Road

CLIFTON SPRINGS, VIC