



8 Neri Drive LEOPOLD, VIC



3



1



2

Quiet Neighbourhood Close To Shops

Securely park vehicles in the lock-up double garage; garden tools can be housed in a separate garden shed. Concrete pathways and simple low-maintenance garden beds make up the remainder of the enclosed backyard.

With solid bones and in a super convenient location, this residence is perfectly liveable as is, but lends itself to a renovation to further modernise. Young families, first home buyers and investors alike should seize this fantastic opportunity today!

Price: \$600,000 - \$650,000

Property Type: House

Land: 655 m2

HAYDEN

Karen Purcell

0448510143

karenp@haydenleopold.com.au

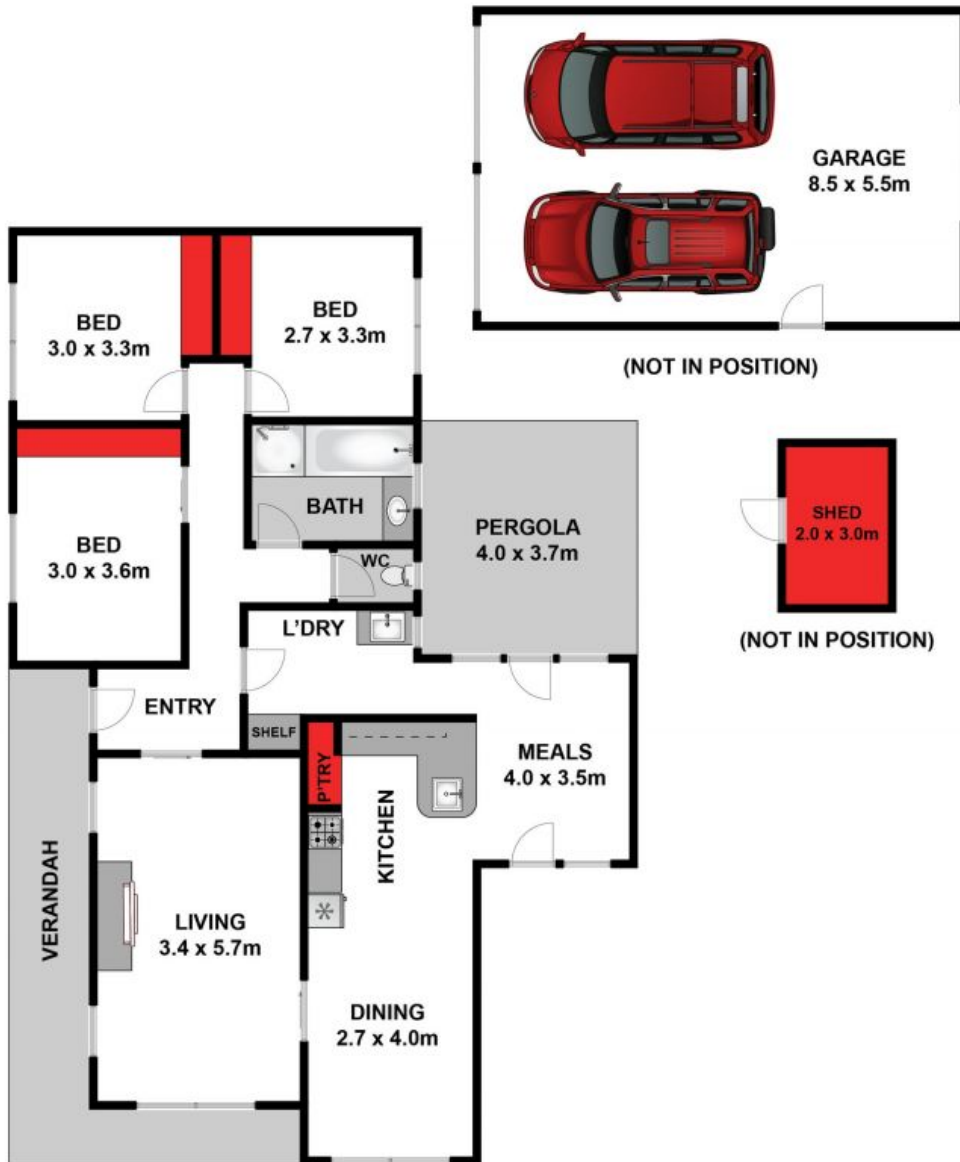

Whilst bwrn.com.au has made every attempt to ensure the accuracy of the floor plan contained here, measurements are approximate and no responsibility is taken for any error, omission, or mis-statement. This plan is for illustrative purposes only.

8 Neri Drive, Leopold

HAYDEN

8 Neri Drive

LEOPOLD, VIC