



13 Roseworth Close LEOPOLD, VIC



4



2



2

An Immaculate And Light-Filled Family Home

Contact For Private Inspection!

Welcome home! This beautifully maintained 4-bedroom family home is perfection inside and out, and ready to meet its new owners. This lovely home boasts a separate living room, a combined Dining/Kitchen/Living area and 4 bedrooms with garden views and built-in robes. The Master bedroom with ensuite is situated in the front of the house and the family bathroom is nestled conveniently between the other bedrooms.

After dinner, relax in the adjoining living-room in front of the gas log fire - a gorgeous feature of this delightful home. Glass sliding-doors open to the beautifully paved entertainment area, a vaulted sunroof covers the courtyard yet allows the sunshine through - a perfect place for gathering family and friends. Transparent cafe blinds allow the light to stream in but keep the cold out. Horizontal shade blinds can be pulled across the sunroof or left open to see the stars at night. This large outdoor entertainment area is sure to i

Price: \$730,000 - \$770,000
Property Type: House
Land: 553 m2

HAYDEN

Karen Purcell

0448510143

karenp@haydenleopold.com.au

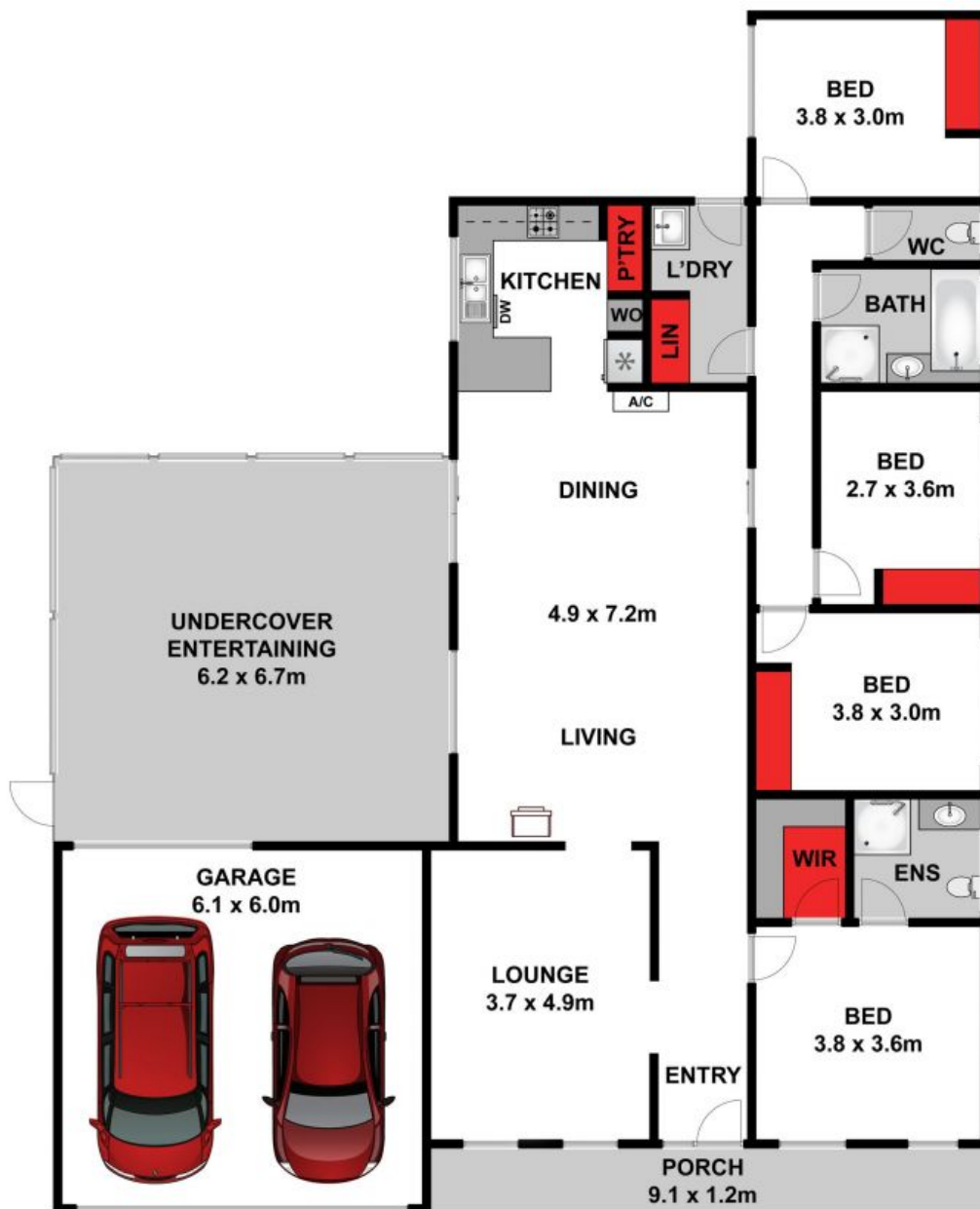

Whilst bwrn.com.au has made every attempt to ensure the accuracy of the floor plan contained here, measurements are approximate and no responsibility is taken for any error, omission, or mis-statement. This plan is for illustrative purposes only.

13 Roseworth Close, Leopold

HAYDEN

13 Roseworth Close

LEOPOLD, VIC