



27 Anzac Avenue LEOPOLD, VIC



3



1



2

## Convenience, Comfort And Character!

This beautifully presented 3-bedroom home is set on a 613sqm (approx.) parcel of land and features a north-facing indoor/outdoor living zone, hardwood timber flooring, a simple yet functional floor plan and pleasant surrounding landscaping. Conveniently located close to the local primary school, Ash Road shops, Gateway Plaza and sporting facilities, the character-filled home has been modernised over the years to prioritise comfort and style.

Bathed in natural light, the main living area is a warm and welcoming space with beautiful hardwood floors underfoot, fresh white walls, and glazing to capitalise on the garden outlook. The contemporary kitchen is well-equipped with a Westinghouse dishwasher, new Harbour oven/cooktop and a striking tiled splashback. Bedrooms all come with generous in-built storage, ceiling fans, carpet and attractive window furnishings and are positioned with easy access to the renovated family-friendly bathroom with bath and stunning timber cabinetry. The adjacent laundry is well-sized, has plenty of storage and direct external access. Ye

**Price:** \$590,000 - \$640,000

**Property Type:** House

**Land:** 613 m2

# HAYDEN

**Karen Purcell**

0448510143

karenp@haydenleopold.com.au

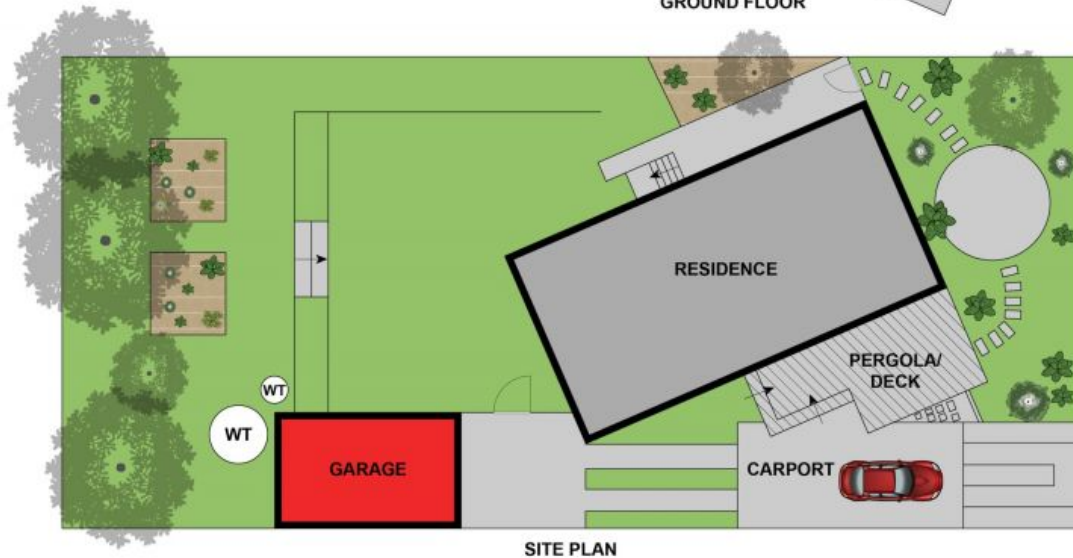
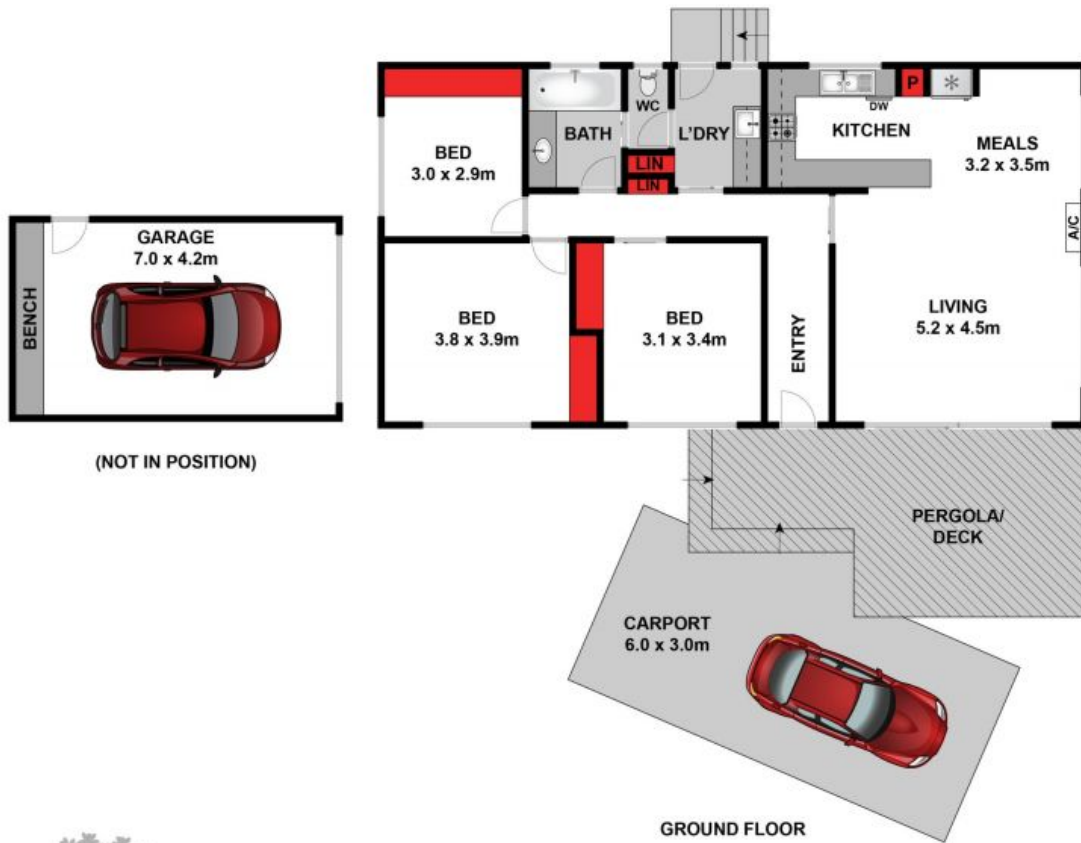

Whilst [bwrn.com.au](http://bwrn.com.au) has made every attempt to ensure the accuracy of the floor plan contained here, measurements are approximate and no responsibility is taken for any error, omission, or mis-statement. This plan is for illustrative purposes only.



27 Anzac Avenue, Leopold

**HAYDEN**

27 Anzac Avenue

LEOPOLD, VIC