



151 The Esplanade TORQUAY, VIC



4



3



2

Coastal Lifestyle With Unbeatable View

This 4-bedroom architectural beauty will have you soaking up an enviable lifestyle on so many levels. Positioned across the road from the beach and opposite parklands and reserves, 151 The Esplanade is the iconic beach address you've been looking for.

Other features include 2-car garage with rear roller door access, 2 instantaneous hot water systems and beautiful hardwood floors.

Price: Auction: Sat 27th Aug @ 11:00am
Property Type: House
Land: 776 m2

HAYDEN

Hayden Real Estate -

Torquay

samh@hayden.com.au

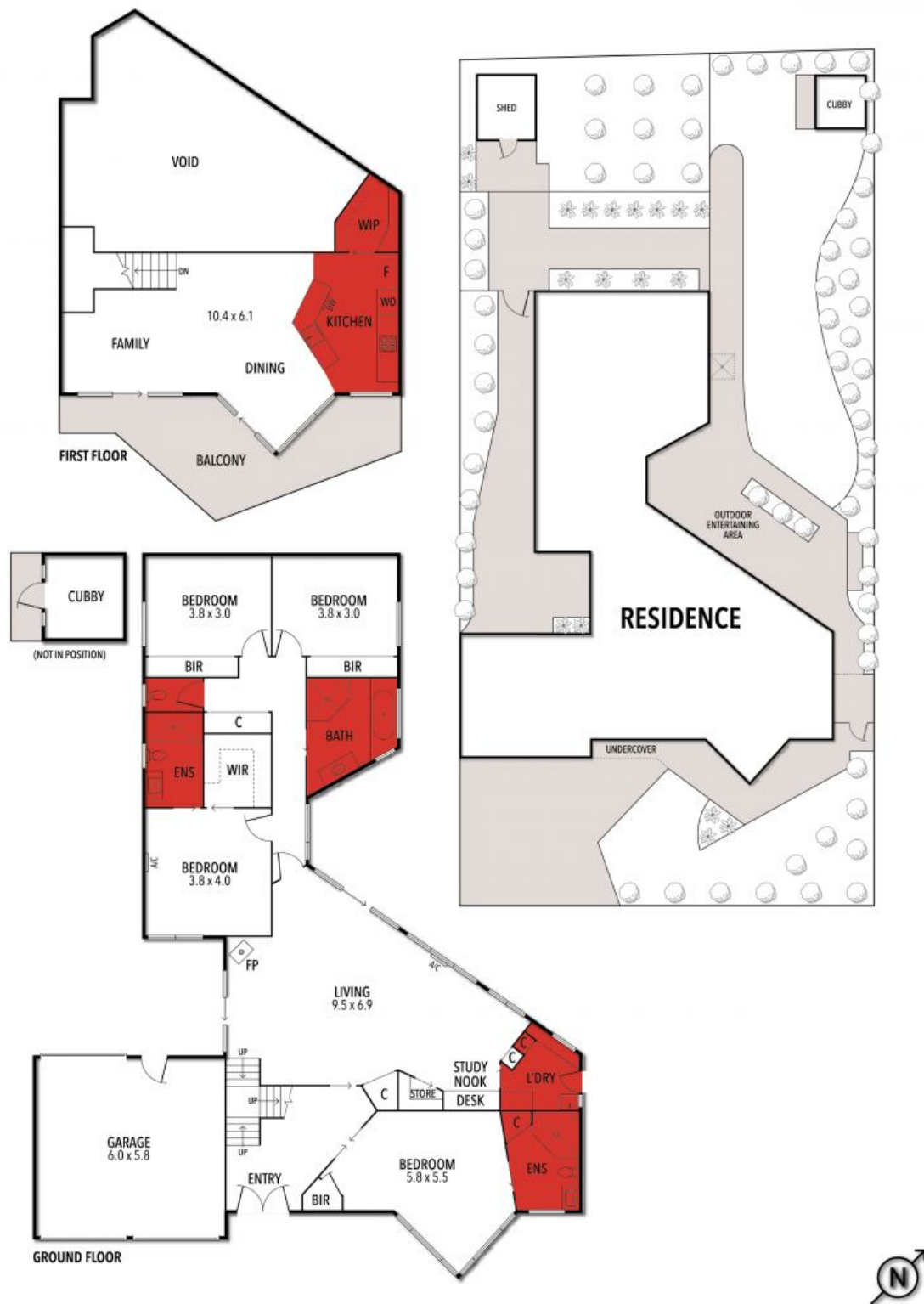

THE ABOVE PLAN IS AN ARTIST'S IMPRESSION ONLY, IT INCLUDES ELEMENTS THAT ARE FOR DISPLAY PURPOSES ONLY AND MAY NOT BE TO SCALE. LANDSCAPING SHOWN IS INDICATIVE ONLY. DIMENSIONS ARE APPROXIMATE.