



61A Simons Road LEOPOLD, VIC



3



1



1

A Low-Maintenance Gem!

Sitting proudly on its own title, this home presents an irresistible choice for first homebuyers, investors and downsizers alike!

The generous living room inspires relaxation, with a sliding door opening onto the garden courtyard. This private outdoor setting invites you to kick back on the lawn and soak up the sunshine. The kitchen/dining zone is well equipped with an oven/gas cooktop and rangehood.

A carefree lifestyle is yours to keep with public transport, local playgrounds and the Dorothy Street shops within easy walking distance. The morning school run will be a breeze for young families, with Allanvale Preschool and Leopold Primary School also a short stroll away. The Leopold Community Centre and Bellarine Rail Trail are within easy reach, while the Gateway Plaza provides you with big-brand stores and supermarkets. To top it all off, a short drive will find you in the bustling hub of Geelong or exploring the picturesque Bel

Price: \$560,000 - \$610,000

Property Type: House

Land: 368 m2

HAYDEN

Karen Purcell

0448510143

karenp@haydenleopold.com.au

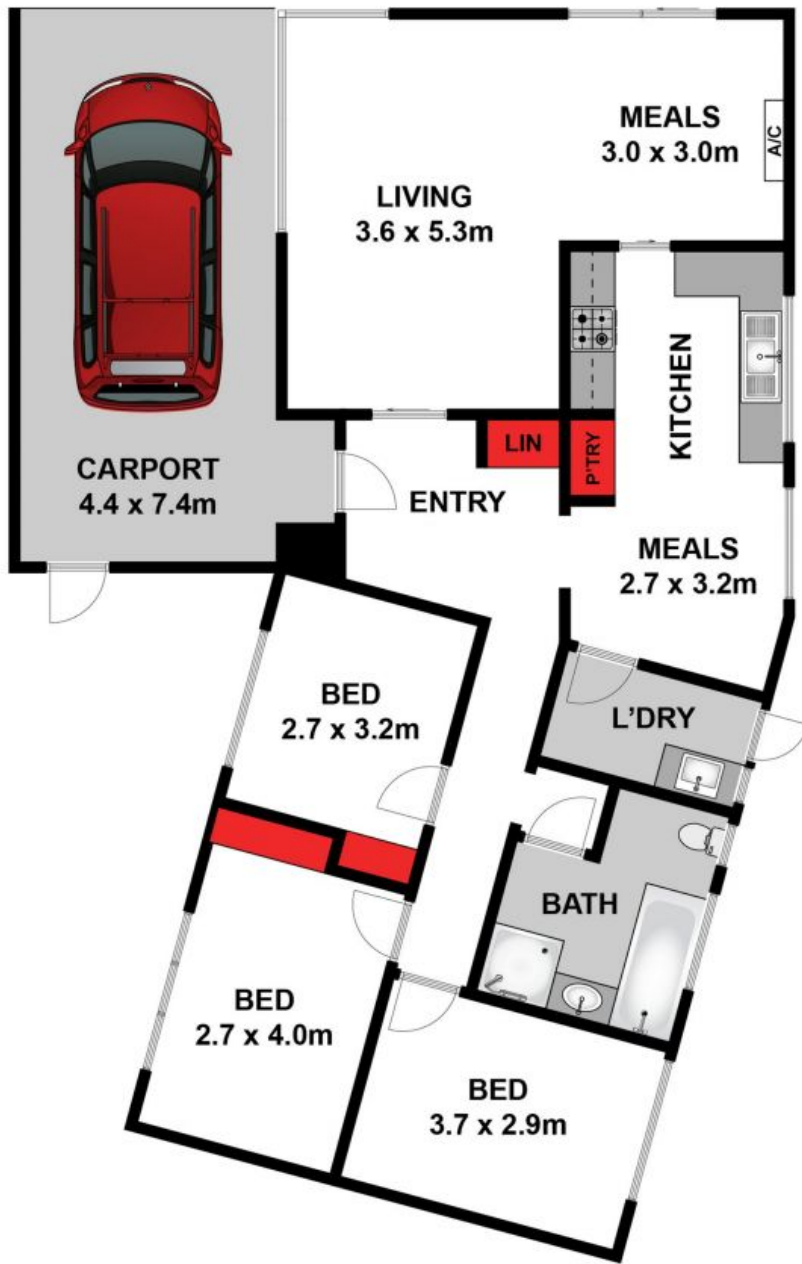

Approx House Area 107m²

Whilst bwrn.com.au has made every attempt to ensure the accuracy of the floor plan contained here, measurements are approximate and no responsibility is taken for any error, omission, or mis-statement. This plan is for illustrative purposes only.

61A Simons Road, Leopold

HAYDEN

61A Simons Road

LEOPOLD, VIC