



7 Melissa Court LEOPOLD, VIC



3



2



2

## Family Living In A Lovely Quiet Court!

This peaceful court places you within easy walking distance to Leopold Primary School and the Leopold Community Hub. Public transport and the local playground are also a short stroll away, along with the Bellarine Rail Trail and Leopold Sportsmans Club. The Gateway Plaza is within easy reach for everyday essentials, while a short drive will find you in the heart of Geelong or exploring the Bellarine Peninsula.

Children have plenty of room to roam and explore in the spacious backyard, which also includes a garden shed. The double carport provides secure backyard vehicle access ? perfect for storing caravans, boats or trailers!

Apply for this property today as this one won't last long!

**Price:** Under Application!

**Property Type:** House

**Date Available:** Thursday, 27th October 2022

# HAYDEN

Hayden Real Estate -

Leopold

samh@hayden.com.au

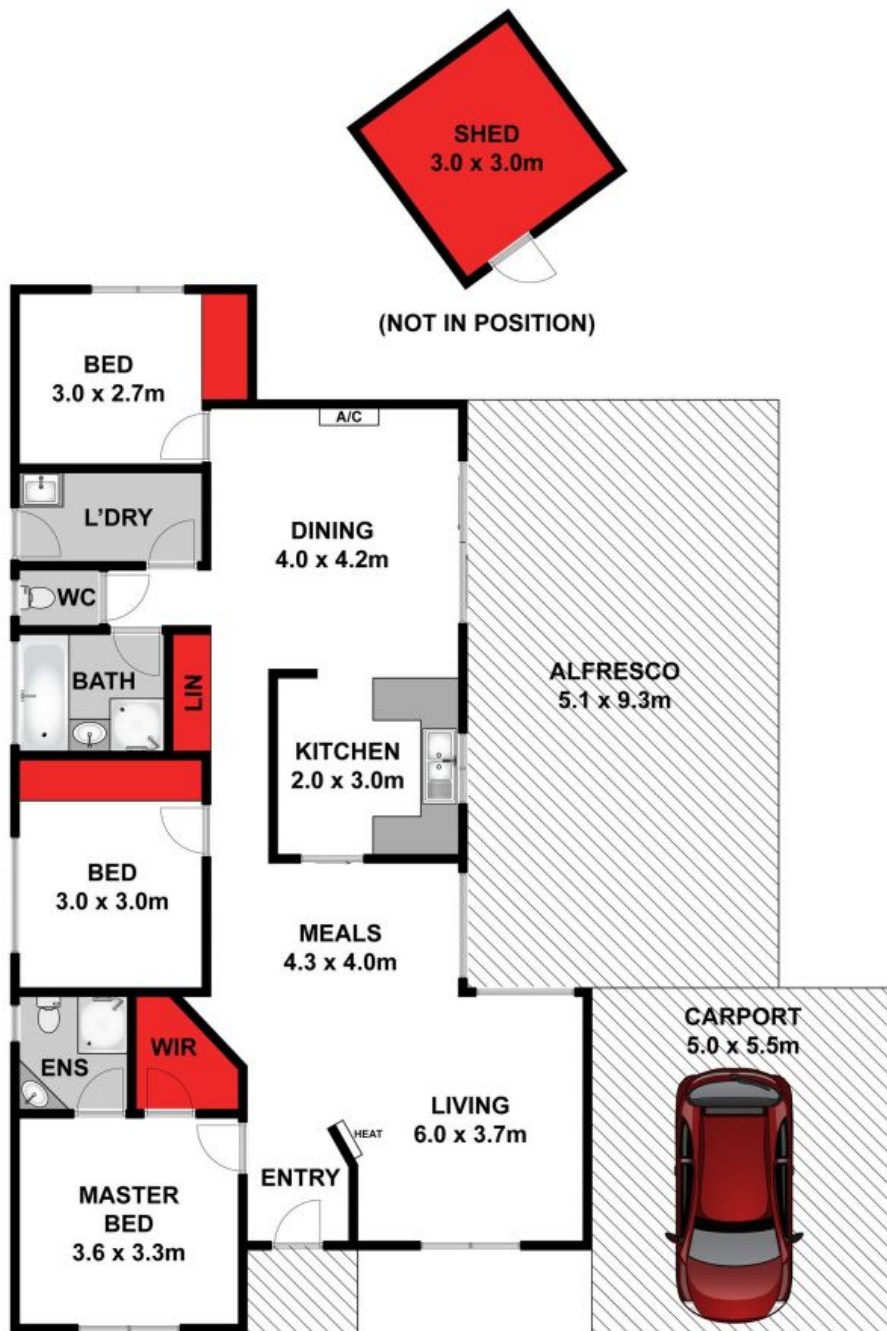

Whilst [bwrn.com.au](http://bwrn.com.au) has made every attempt to ensure the accuracy of the floor plan contained here, measurements are approximate and no responsibility is taken for any error, omission, or mis-statement. This plan is for illustrative purposes only.



## 7 Melissa Court, Leopold

**HAYDEN**

7 Melissa Court

LEOPOLD, VIC