



8 Robbie Court LEOPOLD, VIC



4



2



2

Expanding hidden gem on private cul-de-sac

Set on a large, private block of 866 sqm (approx.) but with only a small street frontage, this generous, family-sized, double-brick home is so much bigger than it seems from the street. Once through the front door, the home almost unfolds to showcase an impressive chef's kitchen that forms the heart of the home. Spacious family living zones envelope the grand kitchen, including a formal sunken lounge and a second informal family area. If you have a big family, and you love entertaining - this one's for you!

Complementing the oversized kitchen and adjacent living spaces are four sizable bedrooms plus study, including one bedroom that could be an ideal rumpus as it is larger and includes extras such as TV points and an external door. The large sun-filled master suite - with Balinese-themed ensuite and WIR - is at the front of the house, overlooking its own private fern garden. In addition, the backyard boasts big spaces, established fruit trees, a hot

Price: \$780,000 - \$840,000

Property Type: House

Land: 867 m2

HAYDEN

Karen Purcell

0448510143

karenp@haydenleopold.com.au

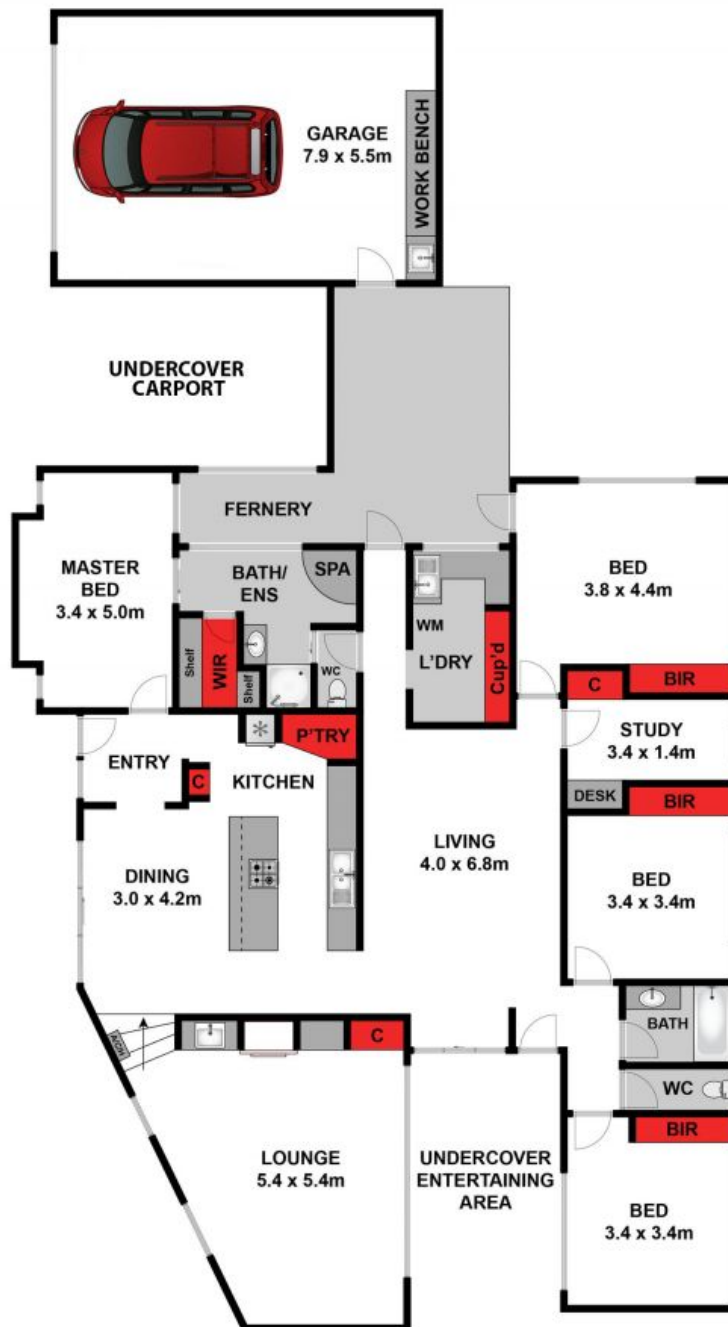

Whilst bwrn.com.au has made every attempt to ensure the accuracy of the floor plan contained here, measurements are approximate and no responsibility is taken for any error, omission, or mis-statement. This plan is for illustrative purposes only.



8 Robbie Court, Leopold

HAYDEN