



3 Heather Court ANGLESEA, VIC



3



1



2

Court Living in Prime Location

Heather Court oozes old school summer holiday vibes from your childhood! A short stroll to the shopping and dining precinct, easy access to the beach and only 200m to the Anglesea River, it's the 3 bedroom beach shack your friends and family will love to visit!

Positioned on a large 682m2 block at the end of a family-friendly court, this cedar-clad home offers boundless opportunity to add personal touches, extend and renovate, or plan for a knockdown re-build (STCA).

Price: Contact Agent
Property Type: House
Land: 682 m2

HAYDEN

Darcy Bennett

0468427359

darcyb@hayden.com.au

Bryan Hayden

0417613250

bryanh@hayden.com.au

3 HEATHER COURT, ANGLESEA

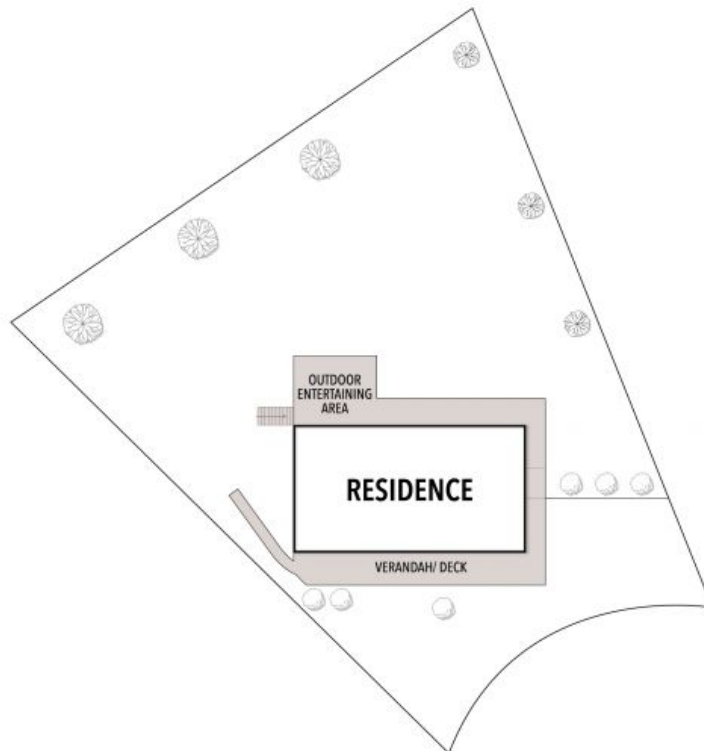
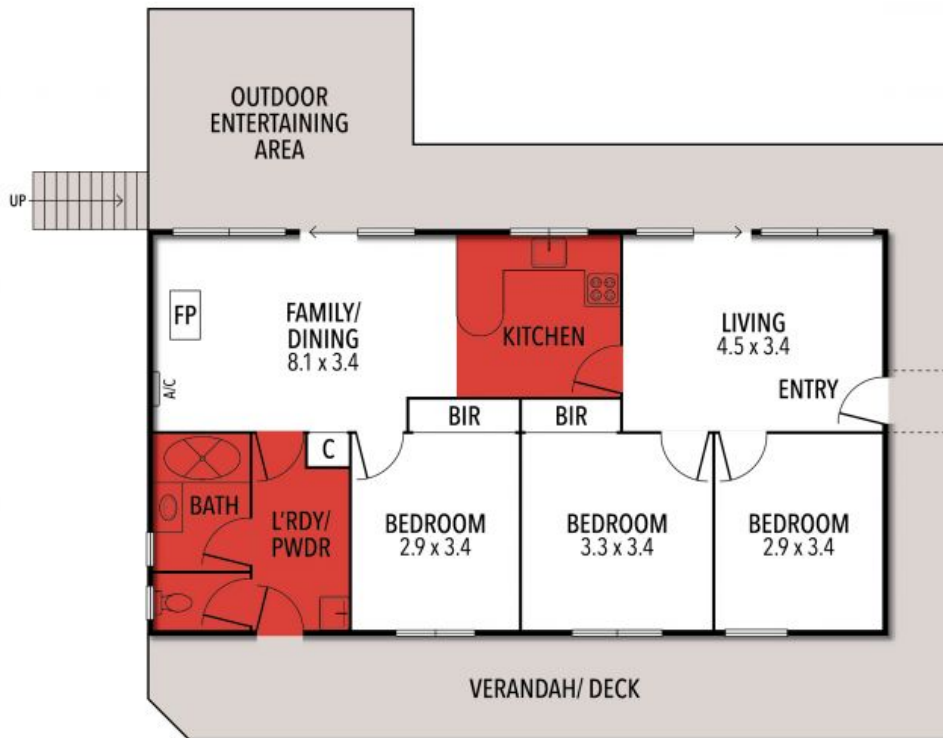

THE ABOVE PLAN IS AN ARTIST'S IMPRESSION ONLY, IT INCLUDES ELEMENTS THAT ARE FOR DISPLAY PURPOSES ONLY AND MAY NOT BE TO SCALE. LANDSCAPING SHOWN IS INDICATIVE ONLY. DIMENSIONS ARE APPROXIMATE.