



2/100 Kensington Road Leopold, VIC



2



1



1

Light, Bright & Overflowing With Style!

When it comes to low-maintenance living, it doesn't get much better than this!

Apply today this gorgeous unit will not last long!

Please note we do not accept 1Form

Price: Application Approved!

Property Type: House

Date Available: Friday, 25th November 2022

HAYDEN

Hayden Real Estate -

Leopold

samh@hayden.com.au

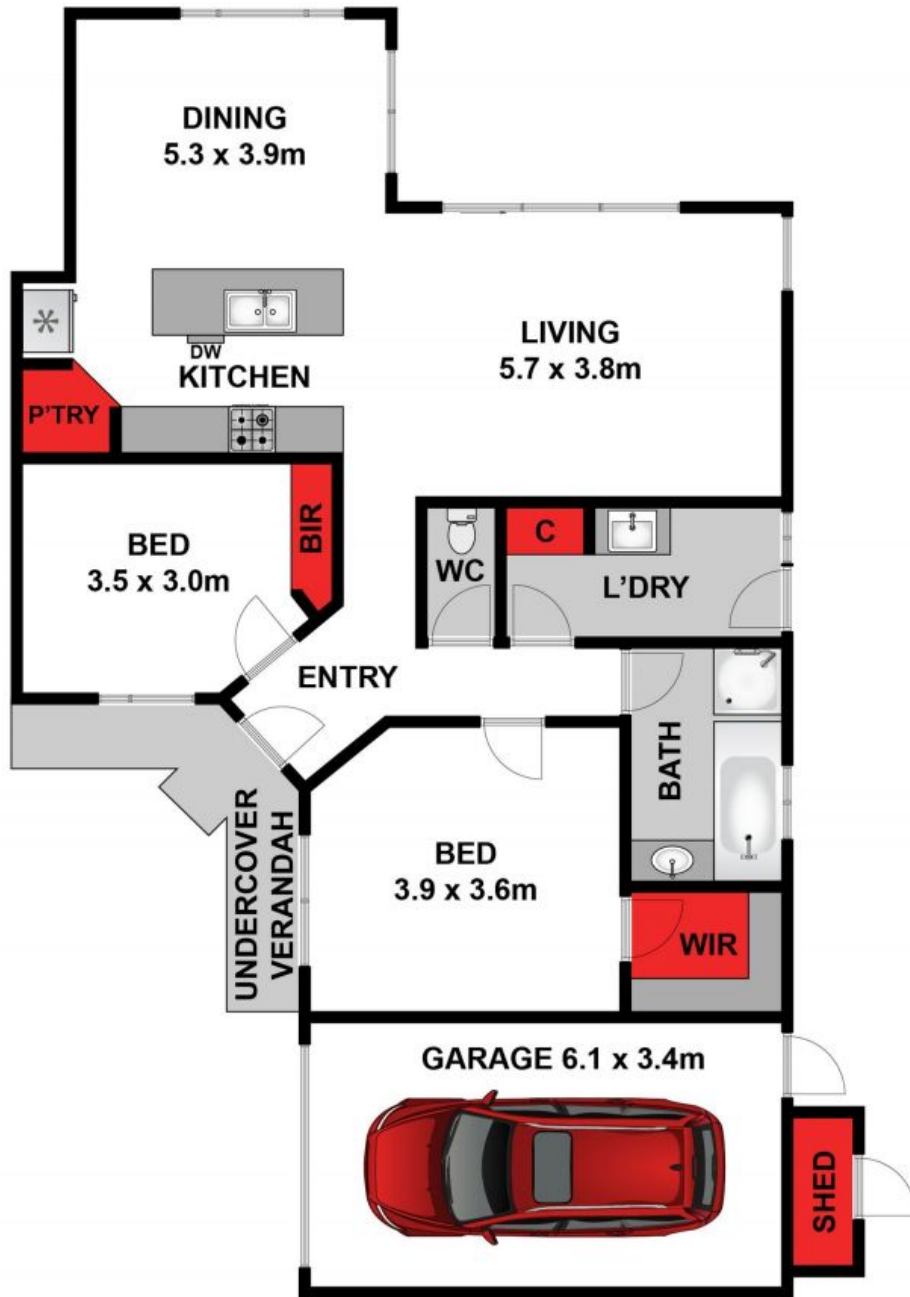

Whilst bwrn.com.au has made every attempt to ensure the accuracy of the floor plan contained here, measurements are approximate and no responsibility is taken for any error, omission, or mis-statement. This plan is for illustrative purposes only.

2/100 Kensington Road, Leopold

HAYDEN

2/100 Kensington Road

Leopold, VIC