



14 Willows Place Leopold, VIC



4



2



1

## Classy Cottage in a Cosy Court!

This well-presented four bedroom family home is located in a quiet court and close to Gateway Plaza and Leopold Primary School.

This large family home offers separate living zones with wood fireplaces and split system for year round comfort.

The kitchen comes with Bellini oven/cooktop, dishwasher and sociable island bench overlooking the open plan dining/living space.

Offering three generous bedrooms with robes and fans. The large master bedroom with fan, walk in robe and ensuite.

This house is surrounded by well maintained gardens including a fire pit for your enjoyment. Garage for one car, an additional carport plus additional backyard shed for storage.

Please also note that we do not accept 1Form applications.

**Price:** Under Application

**Property Type:** House

**Date Available:** Monday, 28th November 2022

# HAYDEN

**Jenny Dries**

(03) 5250 1666

jennyd@haydenoceanogrove.com.

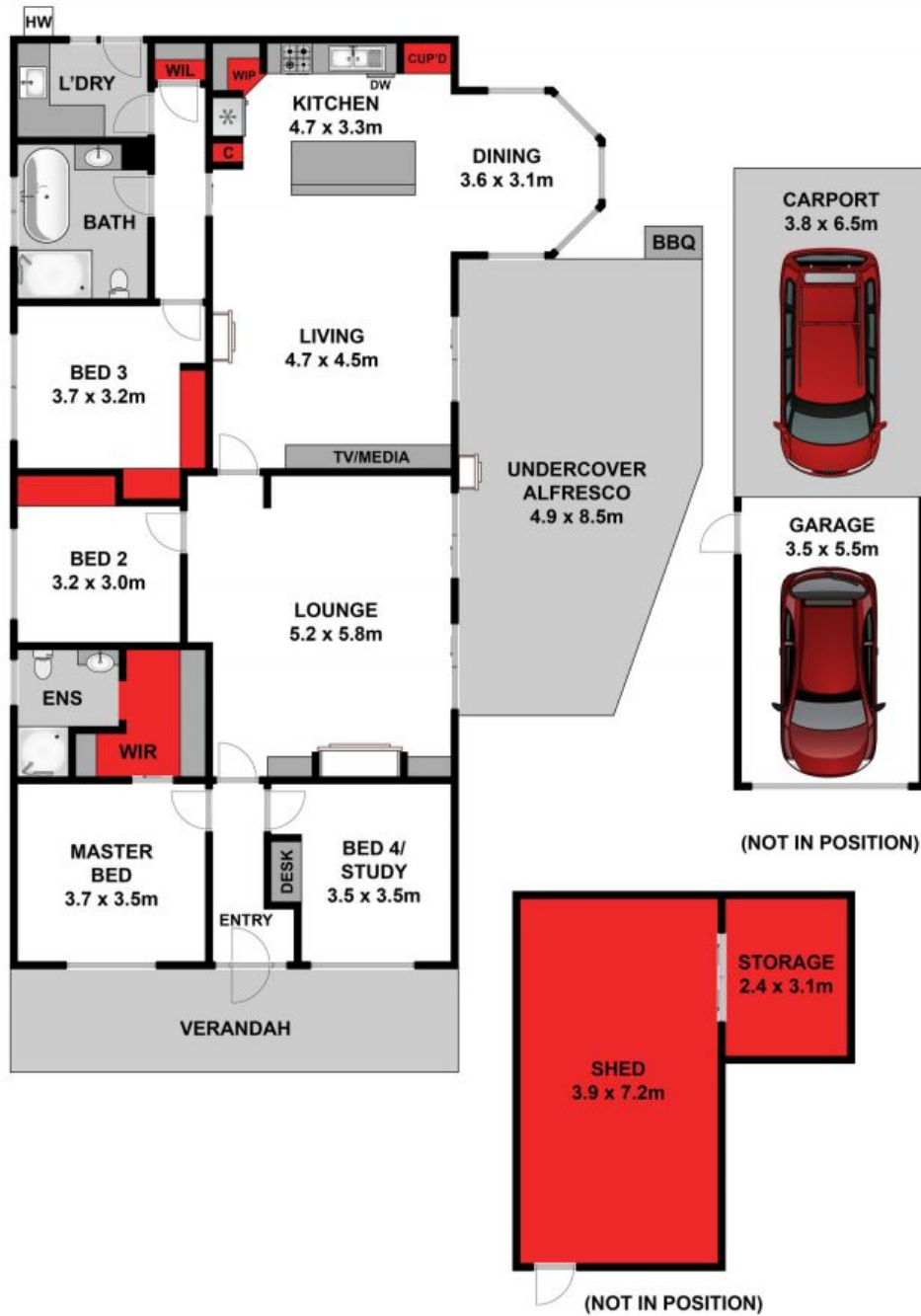

Approx House Area 164m<sup>2</sup>

Whilst [bwrn.com.au](http://bwrn.com.au) has made every attempt to ensure the accuracy of the floor plan contained here, measurements are approximate and no responsibility is taken for any error, omission, or mis-statement. This plan is for illustrative purposes only.



**14 Willows Place, Leopold**

**HAYDEN**

14 Willows Place

Leopold, VIC