



41 Allambie Street LEOPOLD, VIC



3



1



1

Endless Potential In Family-Friendly Leopold!

Occupying approx. 622m², this property presents buyers with endless opportunities! Whether you plan to renovate, wipe the slate clean to build your dream family haven (STCA), or lease out the house while you land bank, the rewards are endless!

Price: \$510,000 - \$540,000

Property Type: House

Land: 622 m²

HAYDEN

Karen Purcell

0448510143

karenp@haydenleopold.com.au

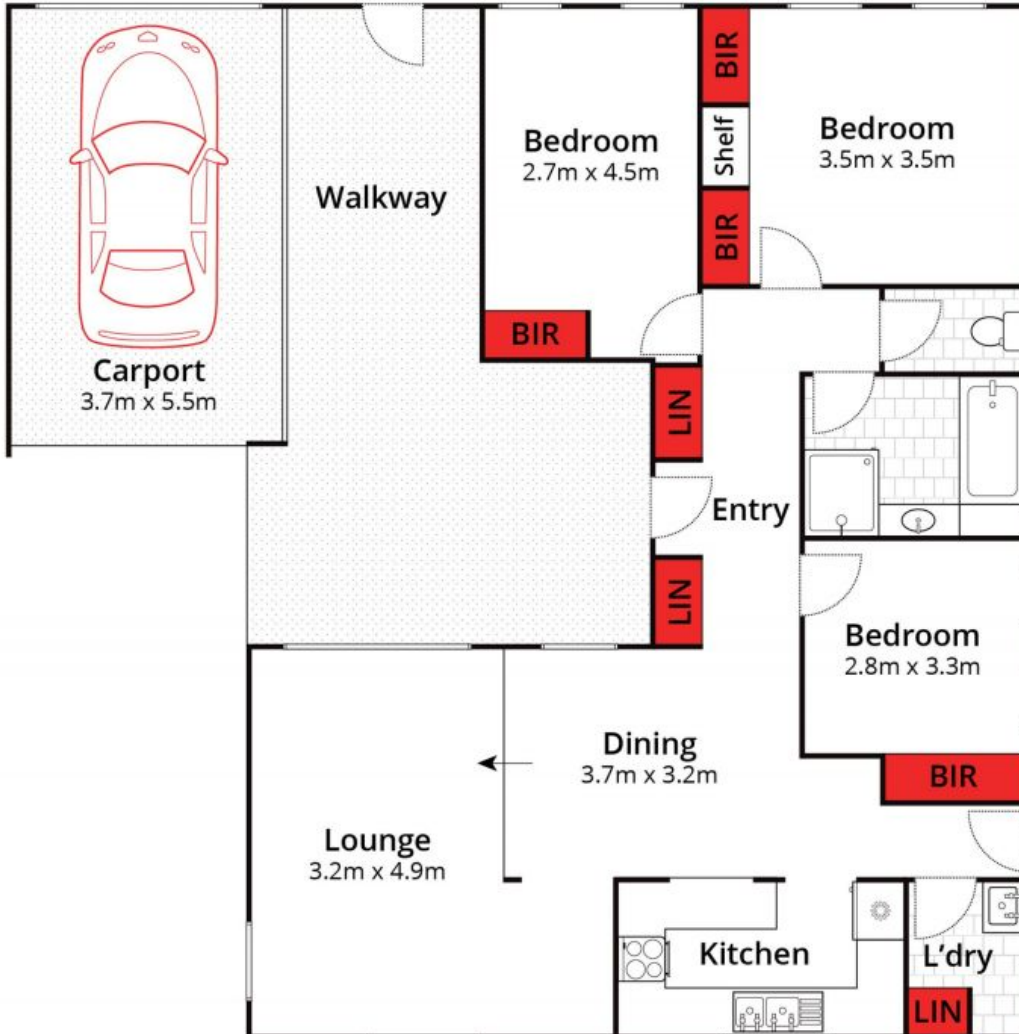

Whilst bwrn.com.au has made every attempt to ensure the accuracy of the floor plan contained here, measurements are approximate and no responsibility is taken for any error, omission, or mis-statement. This plan is for illustrative purposes only.



41 Allambie Street, Leopold

HAYDEN

41 Allambie Street

LEOPOLD, VIC