

8 Barimba Court LEOPOLD, VIC



4



1



7

PRICE REDUCTION- Vendors Say Sell!

Have you been dreaming of superb family living? Boasting sensational entertaining options, a huge backyard and ample off-street parking, this property has something to impress everyone on approx. 997m2!

The large kitchen makes a stunning statement with matte black cabinetry, a tiled splashback, abundant storage and stainless steel appliances (dishwasher, 900mm oven, 5-burner gas cooktop).

Inspection time by booking only (call or email) and will be displayed on this page. View times are subject to cancellation/change until 12:00PM on the day of the open. We advise you check the listing on the day, to ensure the property is still available prior to inspect

Price: \$690,000 - \$740,000

Property Type: House

Land: 997 m2

HAYDEN

Karen Purcell

0448510143

karenp@haydenleopold.com.au

David Pemberton

0419874029

david@haydenleopold.com.au

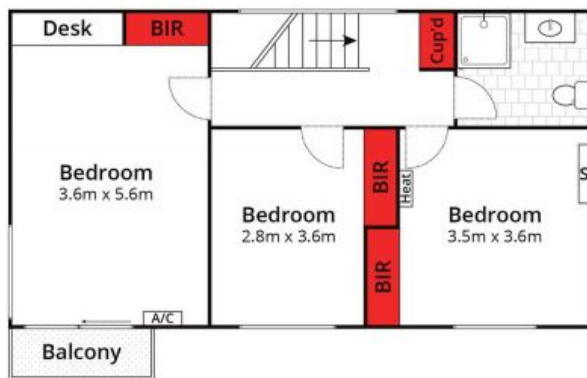

First Floor

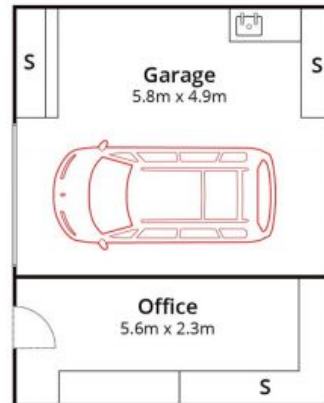

(Not In Position)

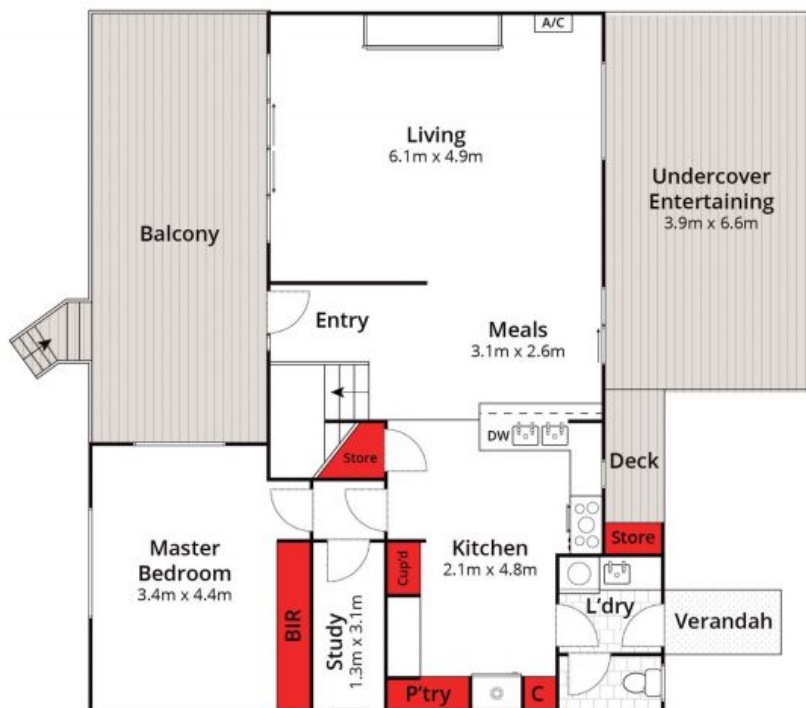

Ground Floor

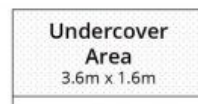

(Not In Position)

Whilst bwrn.com.au has made every attempt to ensure the accuracy of the floor plan contained here, measurements are approximate and no responsibility is taken for any error, omission, or mis-statement. This plan is for illustrative purposes only.



8 Barimba Court, Leopold

HAYDEN

8 Barimba Court

LEOPOLD, VIC