



22 Carlina Court MARSHALL, VIC



The Entertainer

Price: \$680,000 - \$730,000
Property Type: House
Land: 452 m2

HAYDEN

Laurie McGovan

0412167677

laurie@haydengeelong.com.au

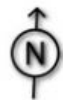
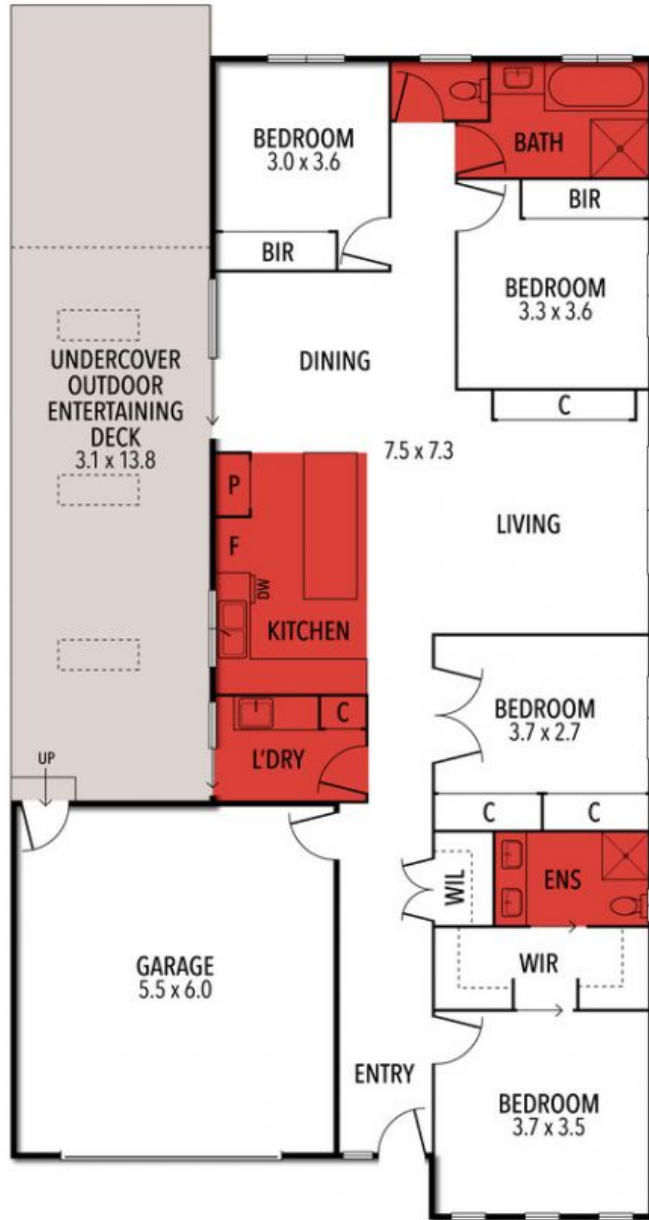

THE ABOVE PLAN IS AN ARTIST'S IMPRESSION ONLY, IT INCLUDES ELEMENTS THAT ARE FOR DISPLAY PURPOSES ONLY AND MAY NOT BE TO SCALE. LANDSCAPING SHOWN IS INDICATIVE ONLY. DIMENSIONS ARE APPROXIMATE.