



2/36 McKillop Street GEELONG, VIC



3



2



2

When Location is Important.

Superbly located on the fringe of the city sits this architectural contemporary townhouse. Consisting of 3 bedrooms, master with ensuite, open plan kitchen with stone benchtops, 2 spacious living areas and secure car parking. The home has a current opportunity to redecorate, add your own touches and personality to this fabulous layout. Just a short stroll to Kardinia Park, Geelong train station, the waterfront or Pakington Street, this may be the lifestyle change you have been looking for.

Price: \$795,000 - \$855,000

Property Type: Townhouse

Land: 140 m2

HAYDEN

Laurie McGovan

0412167677

laurie@haydengeelong.com.au

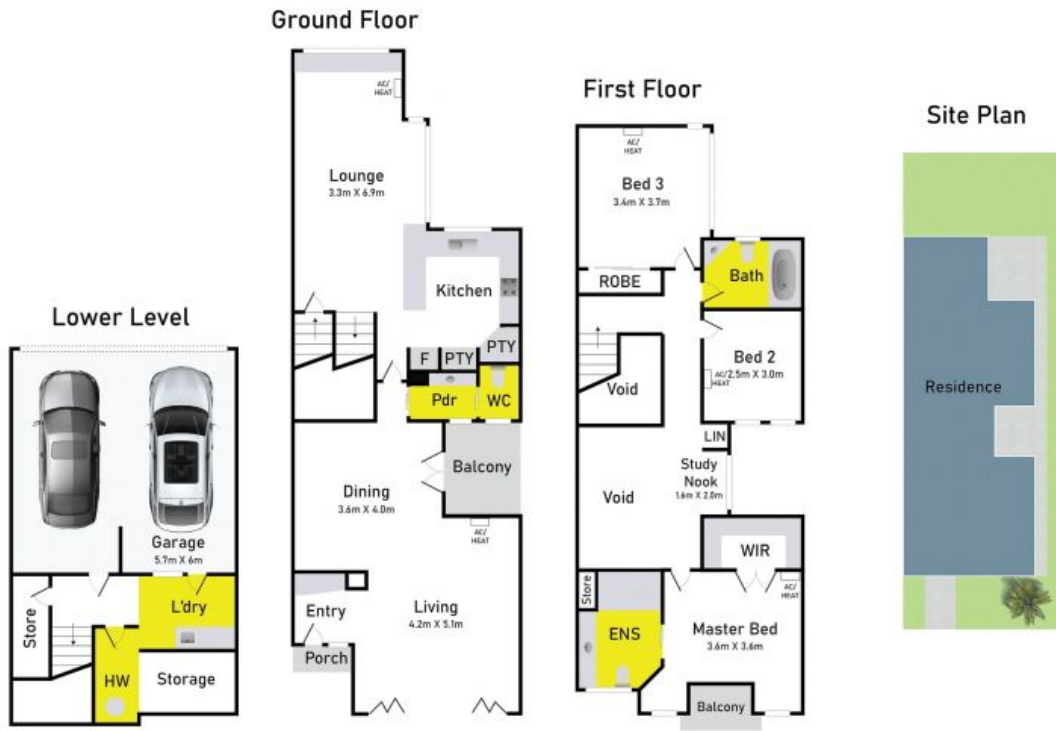

2/36 McKillop Street, Geelong

* Whilst every attempt is made to ensure the accuracy of the floor plan contained here, measurements are approximate and no responsibility is taken for any error, omission or misstatement. This plan is for illustrative purposes only.