



10 Barney Grove LEOPOLD, VIC



### Make Your Homeowner Dreams A Reality!

Boasting backyard vehicle access, this home presents the ultimate opportunity to break into the property market!

**Price:** \$590,000 - \$620,000  
**Property Type:** House  
**Land:** 430 m2



**Karen Purcell**

0448510143

karenp@haydenleopold.com.au

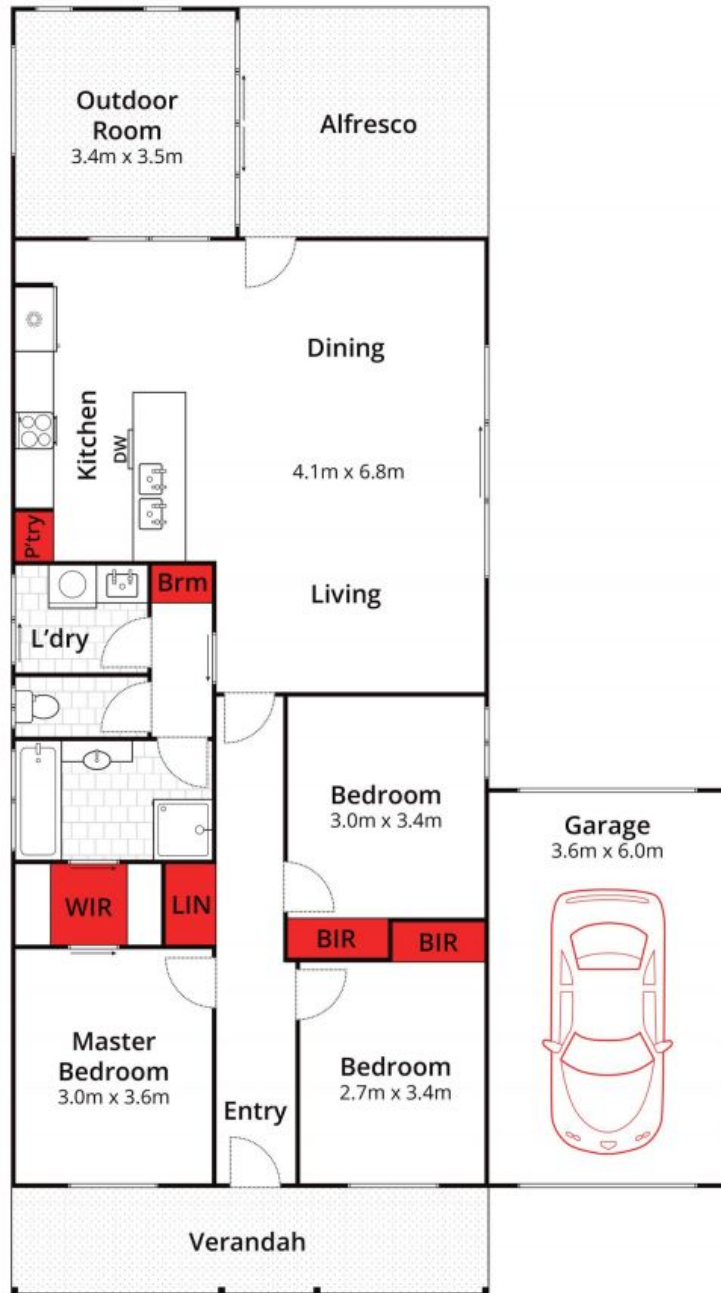

Whilst [bwrn.com.au](http://bwrn.com.au) has made every attempt to ensure the accuracy of the floor plan contained here, measurements are approximate and no responsibility is taken for any error, omission, or mis-statement. This plan is for illustrative purposes only.



**10 Barney Grove, Leopold**

**HAYDEN**

**10 Barney Grove**

**LEOPOLD, VIC**