



10 Barney Grove LEOPOLD, VIC



3



1



1

Make Your Homeowner Dreams A Reality!

Boasting backyard vehicle access, this home presents the ultimate opportunity to break into the property market!

Price: \$590,000 - \$620,000

Property Type: House

Land: 430 m2

HAYDEN

Karen Purcell

0448510143

karenp@haydenleopold.com.au

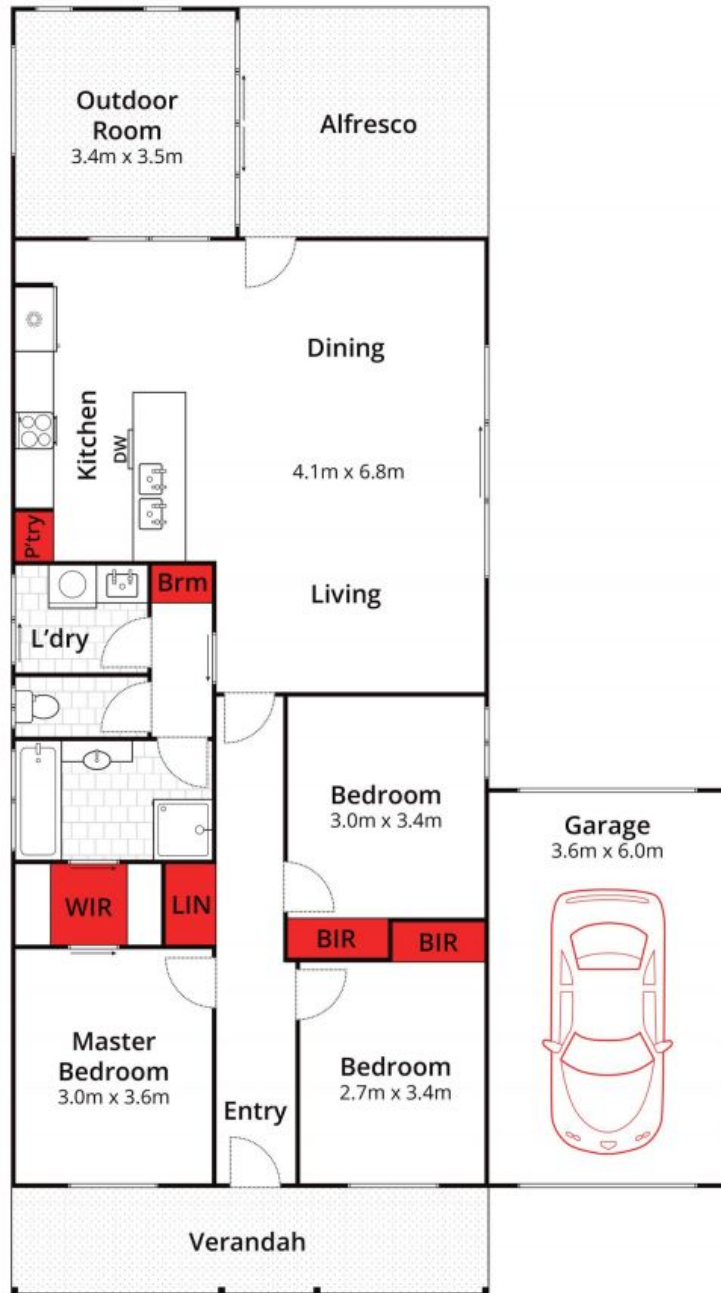

Whilst bwrn.com.au has made every attempt to ensure the accuracy of the floor plan contained here, measurements are approximate and no responsibility is taken for any error, omission, or mis-statement. This plan is for illustrative purposes only.



10 Barney Grove, Leopold

HAYDEN

10 Barney Grove

LEOPOLD, VIC