



HAYDEN

REGISTER TO INSPECT

To secure your inspection of this property, please register using the inspection links provided.

By registering you will automatically be advised of any changes, updates, cancellations, or future inspections.

Application links will be sent once inspections have been attended.

PHOTO ID IS REQUIRED AT ALL OPEN HOMES.

P: 03 5222 3566

A: 2/36 McKillop Street Geelong VIC 3220



2/36 McKillop Street GEELONG, VIC



3



2



2

Sophisticated & Convenient Inner City Living

Located only minutes to the Geelong CBD and Waterfront, Westfield shopping centre, cafes, restaurants, hospitals, primary and secondary schooling, South Geelong station and with GMHBA Stadium and airport shuttle at your doorstep this sophisticated townhouse truly offers a convenient lifestyle to be envied.

With ground floor access from McKillop Street, the property offers a spacious and bright lounge area opening onto the private north-facing courtyard with adjoining formal dining area with high ceilings and a decked entertainment area.

Downstairs there is a large laundry, utility room and additional under stairs storage and access to the double remote garage/parking with rear lane access via McKillop Place. This

Price: \$620.00 per week

Property Type: Townhouse

Date Available: Tuesday, 6th June 2023

Land: 140 m2

HAYDEN

Anna Vines

0493 223 192

anna@haydengeelong.com.au

Kim Sheehan

0493057841

kim@haydengeelong.com.au

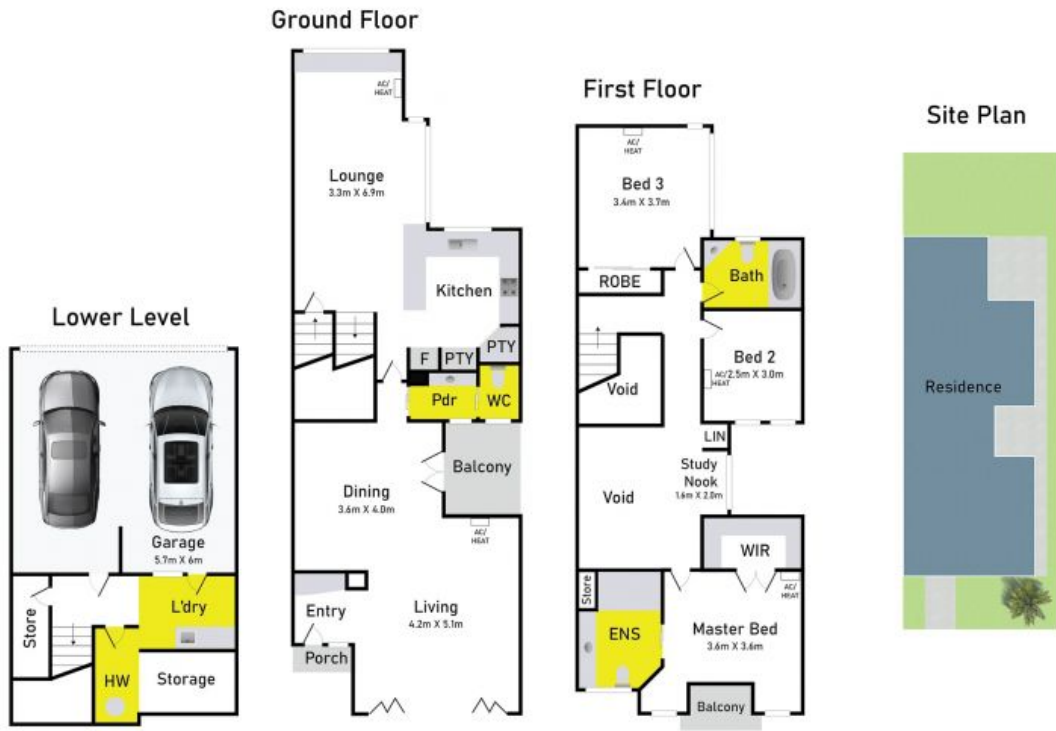

2/36 McKillop Street, Geelong

* Whilst every attempt is made to ensure the accuracy of the floor plan contained here, measurements are approximate and no responsibility is taken for any error, omission or misstatement. This plan is for illustrative purposes only.