



4 Tamar Court LEOPOLD, VIC



4



2



2

### Private location, premium opportunity

Nestled in a quiet court in central Leopold on a generous 849 sqm (approx.) allotment, this family residence presents spacious living inside and out. With an intriguing geometric design, this four-bedroom home is not your run-of-the-mill 70s build and represents a great opportunity for a family to make a mark with their own personal touches (STCA).

The unique floor plan comprises four generous bedrooms, two with built-in robes, serviced by a family bathroom with separate toilet, and a master bedroom with tiled ensuite and wall-to-wall mirrored robes. An enormous rumpus room offers endless possibilities - perhaps a kids play zone or home studio or workshop. The main family lounge area has plush carpet, reverse-cycle air conditioning and a wood-fired heater. A formal dining area connects the living room with the kitchen, where ample cabinetry and breakfast bar create a functional space. Appliances include a gas-powered Westinghouse benchtop oven/stove top and dishwasher. A cosy meals area leads out through glass-sliding doors to the east-facing al fresco di

**Price:** \$620,000-\$660,000

**Property Type:** House

**Land:** 849 m2

# HAYDEN

**Karen Purcell**

0448510143

karenp@haydenleopold.com.au

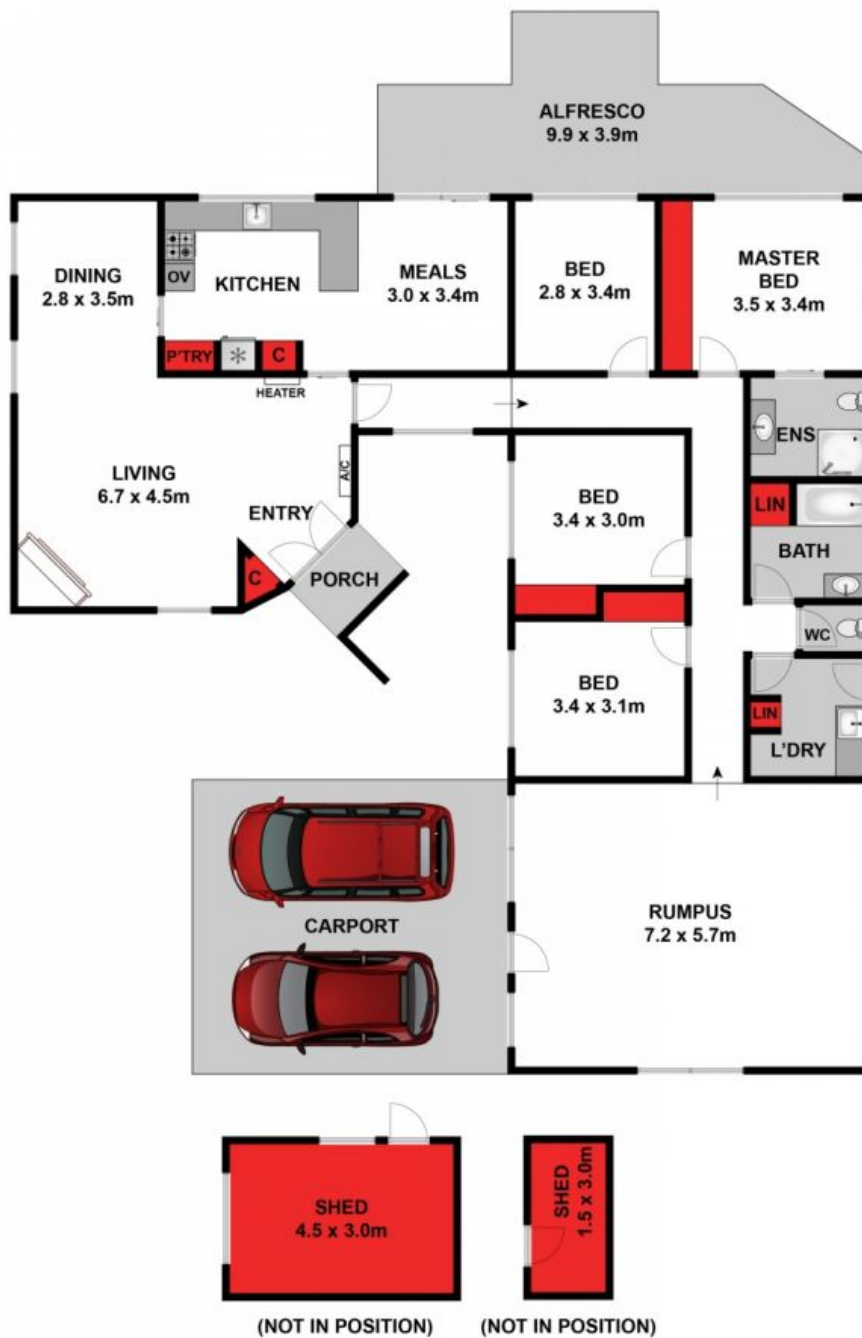

Approx House Area 197m<sup>2</sup>

Whilst [bwrn.com.au](http://bwrn.com.au) has made every attempt to ensure the accuracy of the floor plan contained here, measurements are approximate and no responsibility is taken for any error, omission, or mis-statement. This plan is for illustrative purposes only.

**4 Tamar Court, Leopold**

**HAYDEN**

**4 Tamar Court**

**LEOPOLD, VIC**