



6 Mentelle Street MOUNT DUNEED, VIC



4



2



2

The perfect family home

Upon entering, this new four-bedroom home reveals meticulous family-oriented design. Every detail reflects thoughtful consideration, creating a haven of harmonious living. Features include;

? Master Suite: The house boasts a spacious master suite located at the front. It includes a walk-in robe and an en suite bathroom equipped with a double vanity, shower, and toilet.

? Additional Bedrooms: There are three more bedrooms, each featuring built-in wardrobes, providing ample storage space for the occupants.

? Climate Control: Ducted gas heating and evaporative cooling are installed throughout the home, ensuring comfort in all seasons.

? Large fully landscaped rear yard with low maintenance family living in mind

? Double Lock-up Garage: The house includes a double lock-up garage with internal access, providing secure parking and interior access to the house, ensuring convenience and safety

Price: \$530.00 per week

Property Type: House

Date Available: Wednesday, 16th August 2023

HAYDEN

Anna Vines

0493 223 192

anna@haydengeelong.com.au

6 MENTELLE ST, MOUNT DUNEED

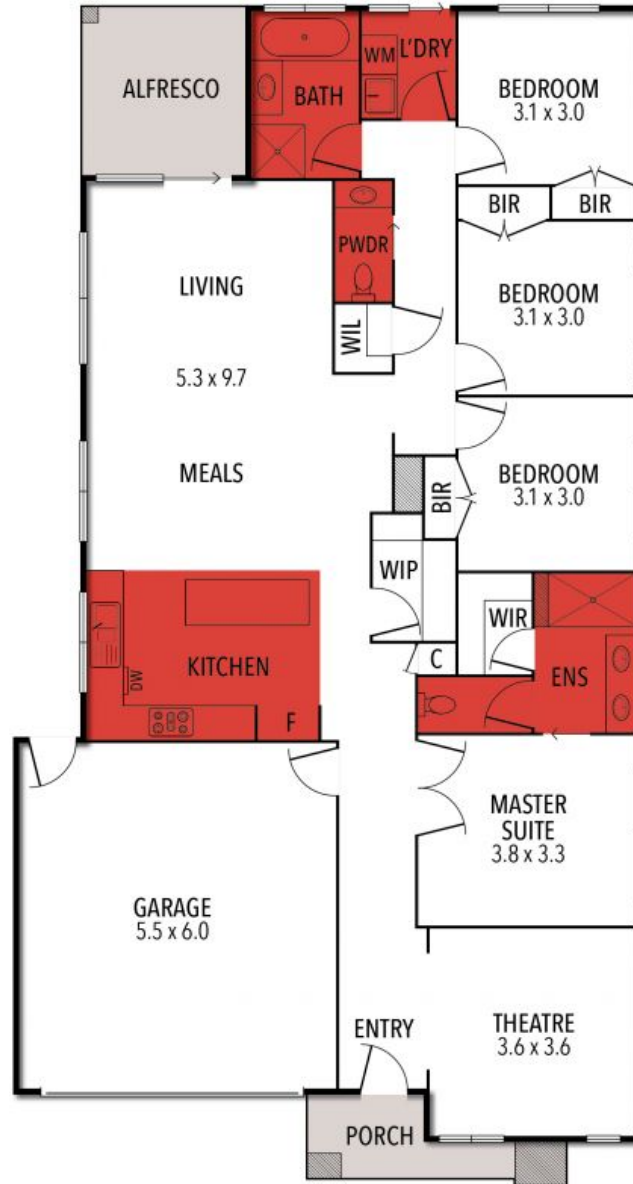

THE ABOVE PLAN IS AN ARTIST'S IMPRESSION ONLY, IT INCLUDES ELEMENTS THAT ARE FOR DISPLAY PURPOSES ONLY AND MAY NOT BE TO SCALE. LANDSCAPING SHOWN IS INDICATIVE ONLY. DIMENSIONS ARE APPROXIMATE.

6 Mentelle Street

MOUNT DUNEED, VIC