



46B Trumper Crescent LEOPOLD, VIC



3



2



2

Stylish Living With A Jacuzzi!

Overflowing with style, this dwelling promises to elevate your lifestyle in a heartbeat!

Price: \$575,000 - \$625,000

Property Type: House

Land: 367 m2

HAYDEN

David Pemberton **Karen Purcell**

0419874029

0448510143

david@haydenleopold.com.au karenp@haydenleopold.com.au

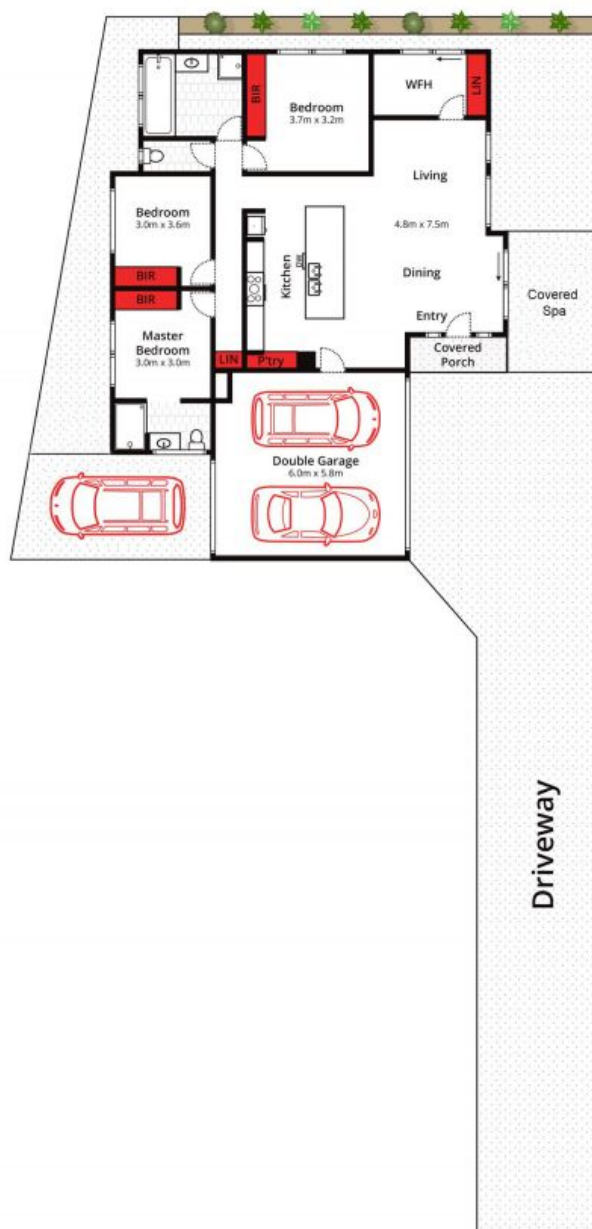

Whilst bwrn.com.au has made every attempt to ensure the accuracy of the floor plan contained here, measurements are approximate and no responsibility is taken for any error, omission, or mis-statement. This plan is for illustrative purposes only.



46B Trumper Crescent, Leopold

HAYDEN

46B Trumper Crescent

LEOPOLD, VIC