



3 Senecio Place LEOPOLD, VIC



3



2



2

Why Build When You Can Move Straight In?

Only a year young, this home promises the carefree lifestyle you've been craving in Leopold!

The flawless interiors evoke a light and airy ambience throughout the home. Northern light sweeps through the open plan living/dining/kitchen zone, which creates a peaceful setting for everyday enjoyment. The kitchen will delight with marble-look benchtops, a built-in pantry and stainless steel cooking appliances (oven, gas cooktop, rangehood).

Situated in a growing neighbourhood, this home places you close to everyday conveniences. A short stroll will find you at the local playground, sporting grounds or Lake Connewarre. Public transport and the Ash Road shops are moments away, while Leopold Primary School and the Leopold Community Hub are within easy reach for families. The Gateway Plaza leaves you spoilt for choice with shopping and dining options. To top it all off, the Bellarine Hi

Price: \$570,000 - \$600,000
Inspect: Saturday, 18th May 2024 10:00 - 10:30
Property Type: House
Land: 338 m2



Karen Purcell

0448510143

karenp@haydenleopold.com.au

David Pemberton

0419874029

david@haydenleopold.com.au

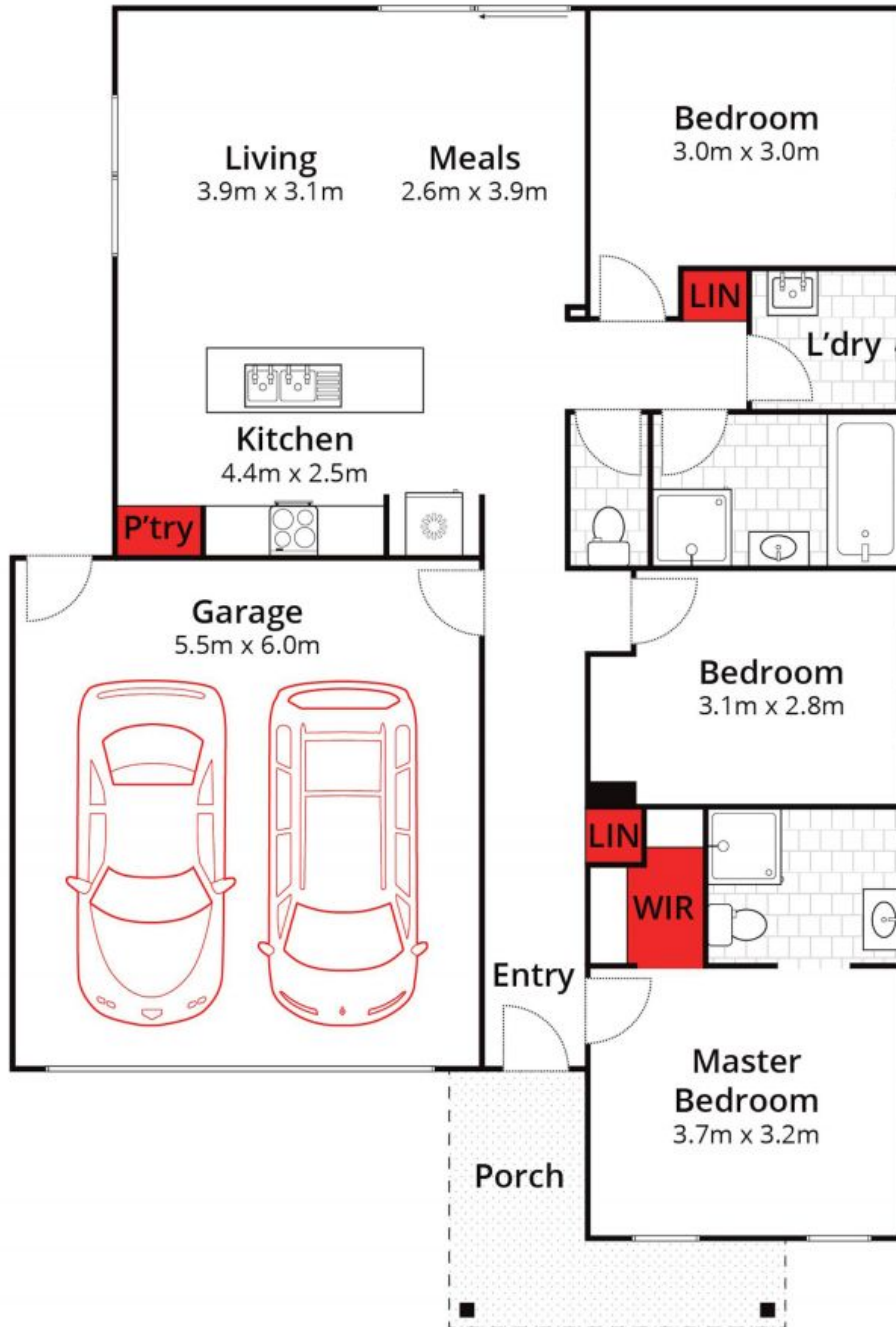

Whilst bwr.com.au has made every attempt to ensure the accuracy of the floor plan contained here, measurements are approximate and no responsibility is taken for any error, omission, or mis-statement. This plan is for illustrative purposes only.



3 Senecio Place, Leopold

HAYDEN

3 Senecio Place

LEOPOLD, VIC