



13 Arden Avenue LEOPOLD, VIC



3



2



3

Modernised 1970's Weatherwood Gem on big block!

Uniquely charming and a little bit quirky, this recently updated home offers an uncompromised blend of modern style and 1970s appeal, set on a large 872 sqm block (approx.) with a wide frontage and circular driveway. Ideally situated in central Leopold, its proximity to schools and kindergartens, plus the local library and shopping centre, ensures an easy lifestyle for young families, downsizers or couples seeking a distinctive living experience.

Situated in a convenient Leopold location close to schools, shops and other amenities, this property is ideal for a discerning buyer who appreciates a home with character and potential. Embrace the quirky charm of this unique home and be the writer of its next chapter -

Price: \$680,000 - \$720,000

Property Type: House

Land: 872 m2

HAYDEN

Karen Purcell

0448510143

karenp@haydenleopold.com.au

David Pemberton

0419874029

david@haydenleopold.com.au

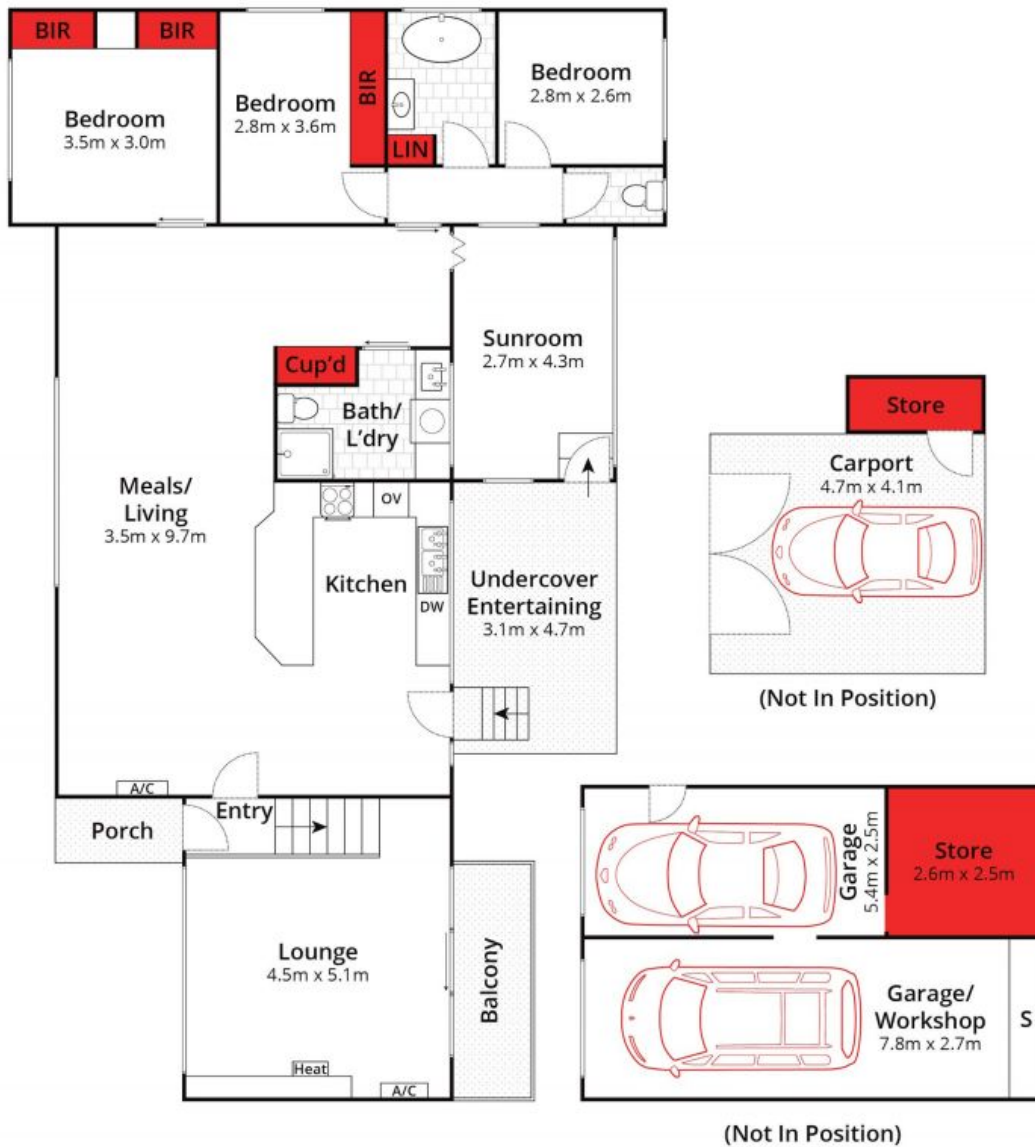

Whilst bwrn.com.au has made every attempt to ensure the accuracy of the floor plan contained here, measurements are approximate and no responsibility is taken for any error, omission, or mis-statement. This plan is for illustrative purposes only.



13 Arden Avenue, Leopold

HAYDEN

13 Arden Avenue

LEOPOLD, VIC