



7 Maddison Court LEOPOLD, VIC



3



1



1

PRICE REDUCTION! Now \$520,000-\$570,000 A Leopold Gem With A North-Facing Backya

Located a short walk to Leopold Primary School, this residence presents a terrific opportunity for first homebuyers and families alike!

Tucked away in a peaceful court, this home also places you within walking distance to sporting grounds and the Leopold Community Centre. The Gateway Plaza is right at your fingertips, while a short drive will find you in the heart of Geelong or making your way to the Bellarine Peninsula. Land 501m2 (approx)

Price: \$520,000 - \$570,000

Property Type: House

Land: 501 m2

HAYDEN

David Pemberton **Karen Purcell**

0419874029

0448510143

david@haydenleopold.com.au karenp@haydenleopold.com.au



(Not In Position)

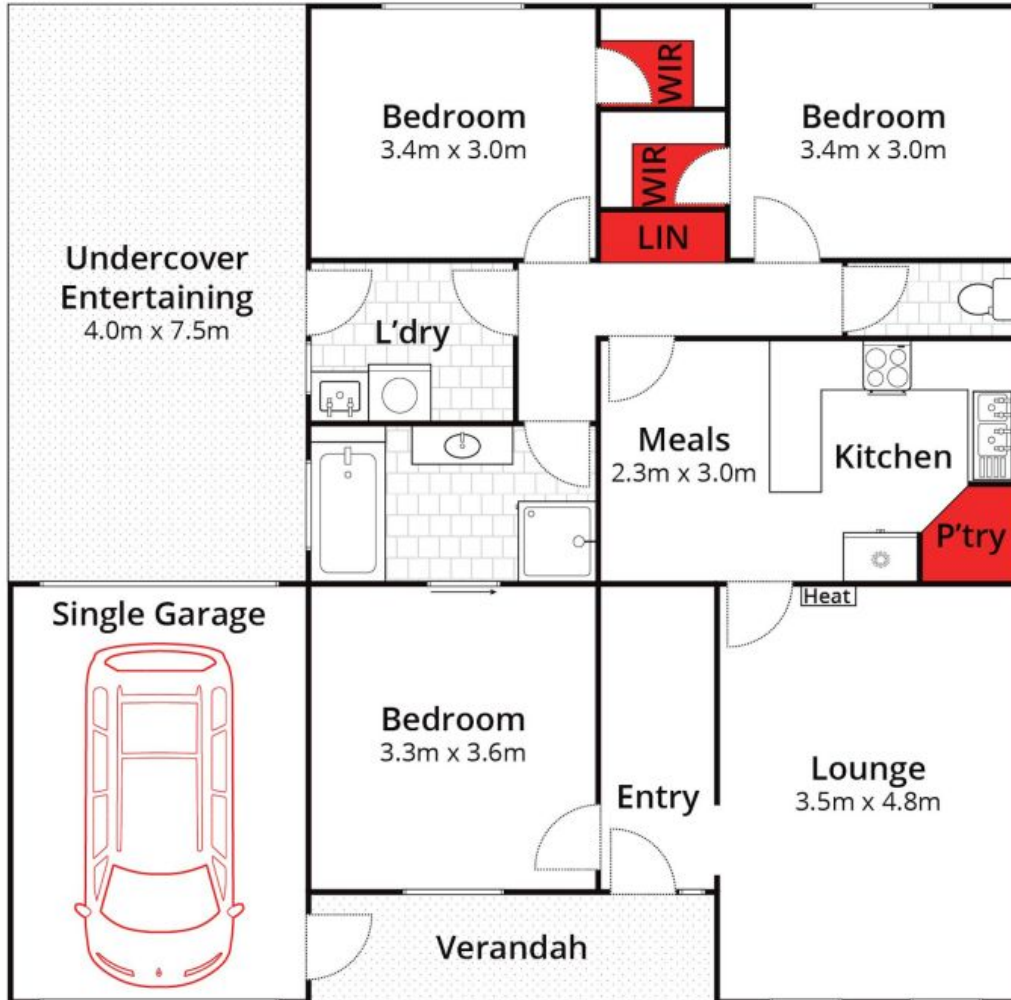

Whilst bwrn.com.au has made every attempt to ensure the accuracy of the floor plan contained here, measurements are approximate and no responsibility is taken for any error, omission, or mis-statement. This plan is for illustrative purposes only.



7 Maddison Court, Leopold

HAYDEN

7 Maddison Court

LEOPOLD, VIC