



131-139 McKiernan Street DRYSDALE, VIC



4



3



6

Make Your Rural Dreams a Reality

Enjoy an idyllic rural lifestyle on this 4.5-acre (approx.) horse property on the outskirts of Drysdale within safe and easy riding distance to the Drysdale Pony Club around the corner. Private and tranquil, this property is ideal for horse lovers but would appeal equally to those wanting to embrace rural living while remaining close to shops and amenities and within easy commuting distance to central Geelong.

Price: \$1,800,000 - \$1,950,000
Inspect: Saturday, 7th December 2024 12:30 - 1:00
Property Type: Acreage/Semi-Rural
Land: 4.57 Acres



Penny Dawson

Lynley Bassett

0448510200

0448515925

penny@haydenoceanogrove.com.au lynley@haydenoceanogrove.com.au

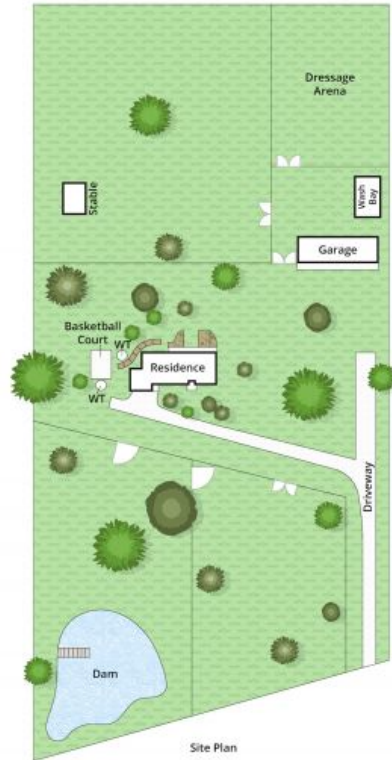
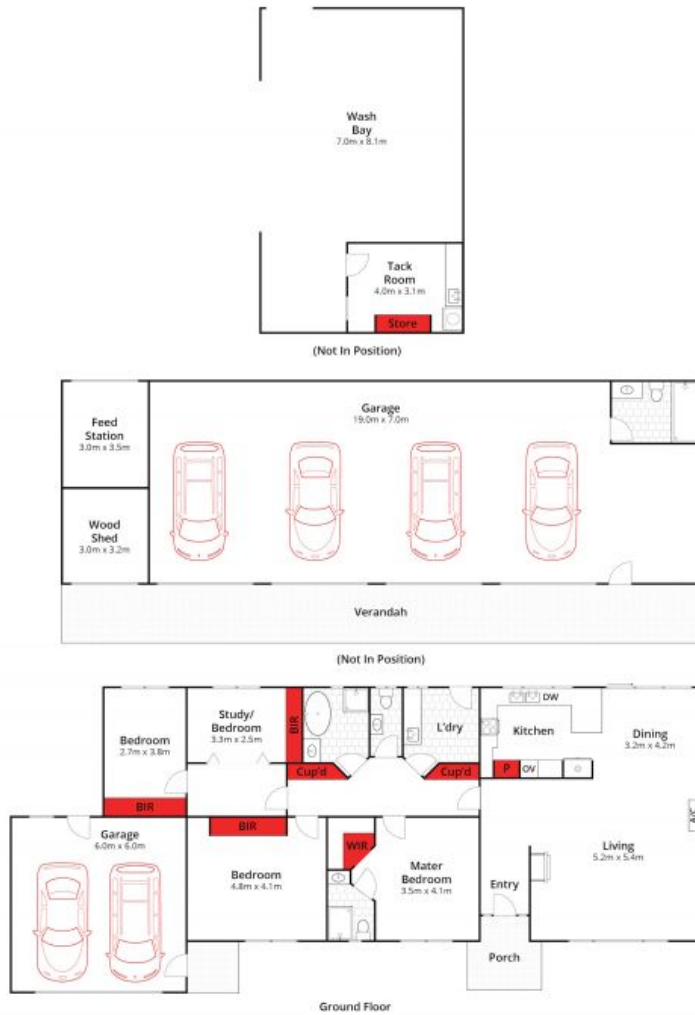

Whilst bwrn.com.au has made every attempt to ensure the accuracy of the floor plan contained here, measurements are approximate and no responsibility is taken for any error, omission, or mis-statement. This plan is for illustrative purposes only.



131-139 McKiernan Street, Drysdale

HAYDEN

131-139 McKiernan Street

DRYSDALE, VIC