



### 9 Grassland Grove LEOPOLD VIC

3 2 2

A home that instantly expands around you, delivering an atmosphere of light, openness and family comfort across two generous levels. High ceilings, full height glazing and an airy modern palette create a sense of calm from the moment you step inside, while sweeping upper-level views stretch across open space to the You Yangs landscape beyond, a daily reminder of the natural landscape on your doorstep.

Multiple living zones allow everyone to spread out with ease, a private front lounge for quiet retreat, a sun-filled family room that spills outdoors and a dining domain perfectly connected to the kitchen. Here, entertainers are rewarded with a La Germania 900mm freestanding oven, long stone benchtops, abundant storage and effortless flow to both indoor and alfresco spaces. Designed for real living, the ground floor also hosts two exceptionally large bedrooms, each fitted with built-in robes and bespoke corner desks ideal for study, creative projects or working from home.

**Type** : House  
**Price** : \$ 815,000  
**Land Size** : 585 sqm  
**View** : <https://www.hayden.com.au/8562649>



**Karen Purcell**  
(03) 5250 1666



**David Pemberton**  
(03) 5250 1666

[For full version visit the website](https://www.hayden.com.au)

<https://www.hayden.com.au>

1/49 Ash Road Leopold VIC  
(03) 5250 1666

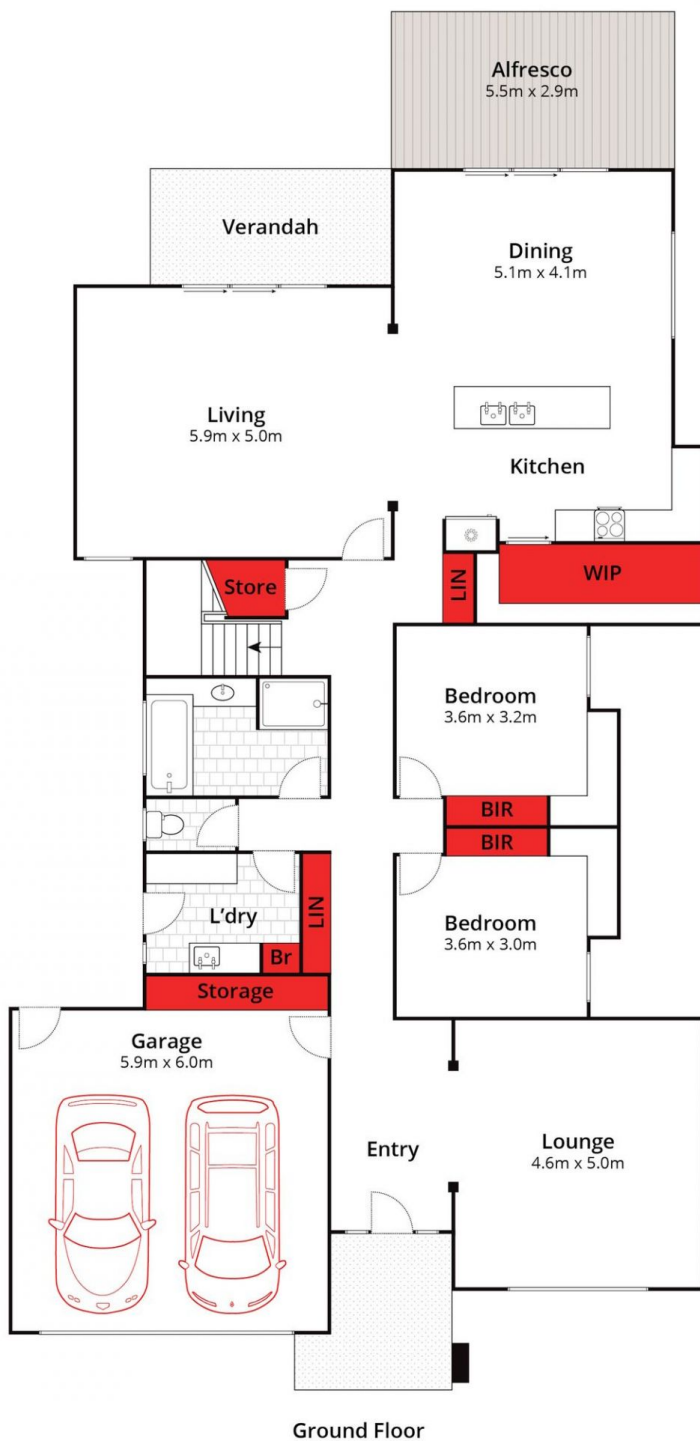

Whilst [bwr.com.au](http://bwr.com.au) has made every attempt to ensure the accuracy of the floor plan contained here, measurements are approximate and no responsibility is taken for any error, omission, or mis-statement. This plan is for illustrative purposes only.



## 9 Grassland Grove, Leopold

**HAYDEN**