



8 Glendale Drive LEOPOLD VIC

3  2  4 

This is where practical living gets a serious glow-up. Immaculately updated and perfectly placed on a flat corner allotment, this three bedroom home delivers the kind of flexibility buyers chase but rarely find. Stylish interiors, easy entertaining, secure storage for the big toys and a lifestyle position that keeps everyday convenience firmly on your side.

Step inside and the mood is instantly fresh, bright and welcoming. The open plan kitchen, meals and living domain is the social hub of the home, designed for everything from busy weekday breakfasts to slow Sunday catch ups. The galley kitchen makes a confident statement with quality stainless steel appliances, a striking splashback, excellent storage and a long island bench ready for coffee, homework, grazing platters or a glass of wine while dinner comes together. Sliding doors open the living space straight onto the covered alfresco, where the louvred roof lets you dial up the sun or pull back the elements for year round use.

Type : House
Price : \$ 721,000
Land Size : 415 sqm
View : <https://www.hayden.com.au/8654028>



Karen Purcell
(03) 5250 1666



David Pemberton
(03) 5250 1666

[For full version visit the website](https://www.hayden.com.au)

<https://www.hayden.com.au>

1/49 Ash Road Leopold VIC
(03) 5250 1666

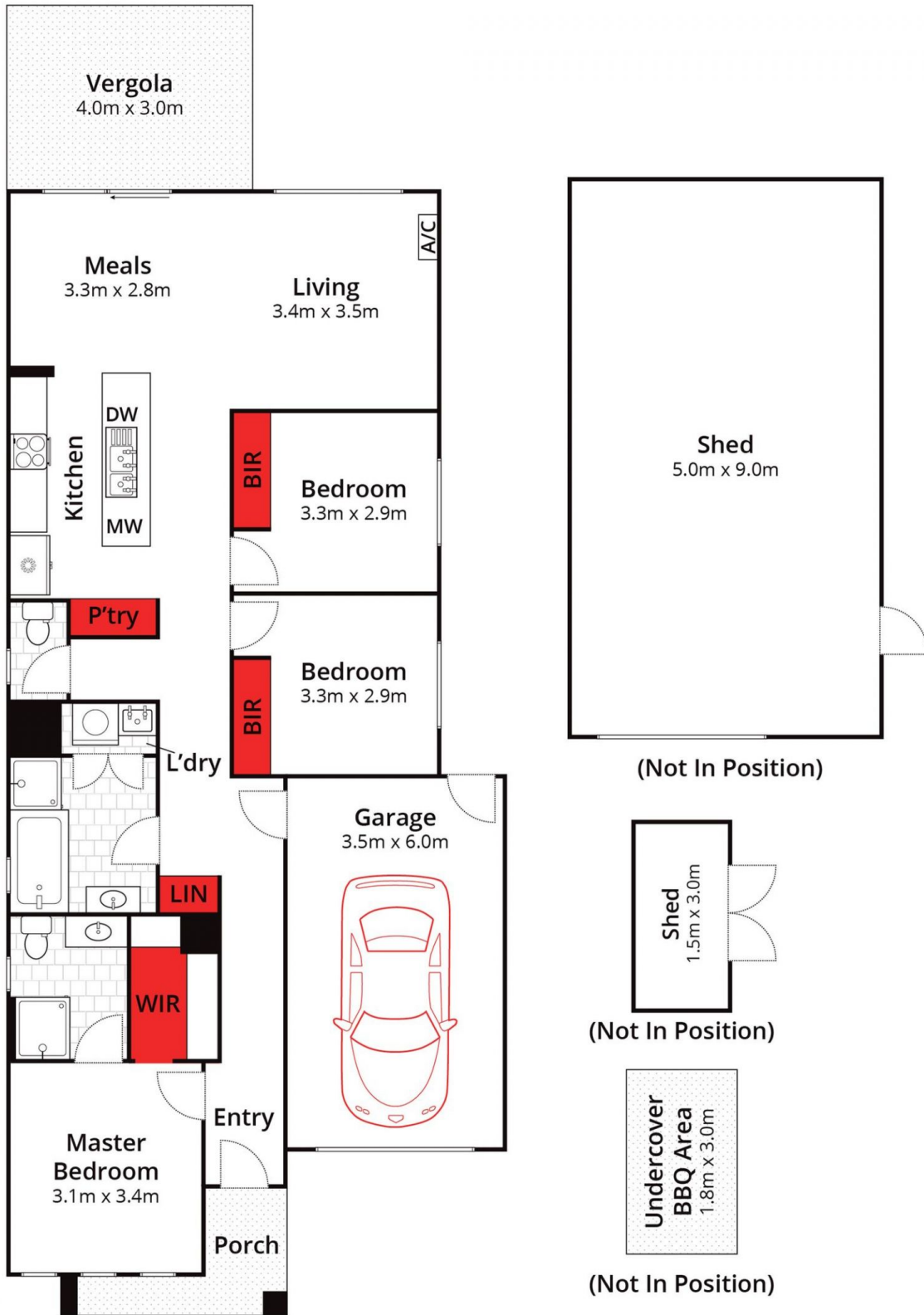

Whilst bwr.com.au has made every attempt to ensure the accuracy of the floor plan contained here, measurements are approximate and no responsibility is taken for any error, omission, or mis-statement. This plan is for illustrative purposes only.



8 Glendale Drive, Leopold

HAYDEN